



MAGNETIC TOOLS
& SCREWDRIVERS COLLECTIONS



STAND TOOLS has been establishing in Taiwan since 1988. Because of persevering, training, acting, trying, looking for better quality and STAND TOOLS successfully built a perfect foundation. Although there are limited resources, STAND TOOLS grows up steadily due to the accomplishments of new products, complete sales network and efforts of all staff & researchers.

In order to manufacture products efficiently, increase the quantity of output, and improve the working environment, STAND TOOLS moved and extended the factory in 1996. It was the harsh time since the devaluation of New Taiwan Dollar. However, STAND TOOLS not only passed the depression but also kept the sales growth. Moreover, because better service. It created outstanding records for a decade.



Facing the violent competitions in the hand tool market, the rapid improvement in 1998. Furthermore, STAND TOOLS standardized the production procedure and got the ISO 9001 certification in March in 1999. The enables STAND TOOLS have more competitive advantages than other manufacturers and trade companies Besides. STAND TOOLS established the CIS, Corporate Identify System, the same year. CIS is useful for improbing the organizing policy, raising the employees' centripetal force & responcebility, and unifying the thinking and befating Nevertheless, it is helpful for unifying the vision identification and emphasizing. our own grand image which males the company much more competitive.

TO keep the edge in various international markets, STAND TOOLS always pays attention to management concepes of Professiona, Creatibity, and Sincerity. More new products and long-term benefits will be mand for the customers who support STAND TOOLS all the time



Service Ranges	ODM, OEM, Private Brand Exporting
Product Lines	Magnetic Tools, Screwdriver, Hardware
Factory Area	5,000 Square meters
Employees	50
R&D Cost/Annual Seles	15%

CONTENTS

Company Profile	1
Awards	2
Magnetic Holder	3 - 6
Magnetic Sweeper & Finder	7 - 11
Magnetic Rack	12 - 14
Magnetic Tray	15
Inspection Tool	16 - 20
Other Magnetic Tool	21 - 23
Tool Set	24 -29
Angle Driver	30
Speed Chuck/Other Tool	31
Ratchets	32

R&D Makes Stand Tools Stand Out above the Competitors

For decades, Stand Tools Enterprise Co., Ltd. has been propelling itself to the top echelon in the ratchet screwdriver and magnetic tools field. To be the global leader in this category, STAND TOOLS should be attributed to the constant innovation.

Most STAND's remarkable rise can be attributed to its president, Jason Shiao, and the 50 or so employees. STAND has enviable profit margins because of efficient management and outstanding R&D capability.

"Stand is the top ratchet screwdriver maker," Shiao claims. "We have most models, the largest production volume, the most comprehensive function options and combinations of our products. We expect to become the world's top magnetic tool supplier before long."

Born to Design

Stand's rapid success is based on the company's excellent capability in innovation and development. Shiao currently heads an R&D team staffed by five talented experts. "Innovation and development are my work, hobby and life," Shiao says with a smile.

Shiao is an industry innovator with over 23 year R&D experience in electrical circuitry, machinery, and hand tool design. The indefatigable executive sleeps only four hours a day and spends all of his available time researching and designing in anything interesting to him, such as factory layout, new equipment, or a hydraulic cooler for a central processor.

"There is an R&D-oriented soul in our company," Shiao says. "It exists in my passion of invention and everyone who visits my office will notice it. I consider it is enthusiasm." In front of his desk, there is an expensive high-end fuse deposition modeler (FDM) for rapid product prototyping, enabling him to indulge his passion whenever he wants to. According to Shiao, FDM can turn out a prototype of screwdriver handle within four to eight hours, compared with the standard 24 hours by using other techniques. FDM produces samples that resemble the real thing in appearance, color and function, and it can link directly to mold development machinery, saving both time and money.

Due to his zeal for R&D, STAND has registered more than 200 patents and continued to register about one or two more each month. "We have become a synonym for innovation in the industry," Shiao says. Rapid and cost-effective development capability is also strengthened by the company's long-term experience and mold-development capability. "We adopt core-change molds in our plastic-injection parts production. The advanced and high-precision molds, though relatively expensive, save us a lot of time and cost in developing mold for new handles."

STAND's strong development capability also bases on its superior know-how in utilizing both traditional and advanced materials: plastics, alloys, and magnetic steel are used in its products. Such know-how enables STAND to compete with other foreign competitors.

Outstanding Performance

STAND now supplies for over 80% of Taiwan's exports in the ratchet screwdriver category and magnetic tools. STAND has developed over 5,600 standardized parts that can be assembled into a nearly infinite variety of screwdriver models meeting any function or target price customers demand. "The more pieces you have, the more functions, styles, and price combinations you can have," Shiao says. STAND now provides over 1,700 ratchet & multi-function screwdriver models, and the number is growing up. The average number of parts of gearless ratchet screwdrivers produced by STAND is over 30 items which make the products precise, functional and durable. STAND has sold over 30 million units of one type of ratchet screwdrivers alone in just the past few years. It is obvious evidence that STAND's products are popular and competitive.

The ISO9001-certified STAND currently outputs about 600,000 ratchets and gearless screwdrivers per month at its 6,000-square-meter assembly plant in Taichung, central Taiwan. "Our close and long-term relationship with over 370 satellite plants has made us become an extremely streamlined maker," Shiao says.

STAND is also an expert of making magnetic tools. Magnets are very common in our life. But making magnets become tools is an art. When the demand of iron tools & machines increases a lot, it's much easier to enter the magnetic tools. "Magnets are not magnets any more." Special and user-friendly design makes users spend less time cleaning the screws or nails on the ground, enjoying the convenience from the unique utility and avoiding missing tools again and again. "Human beings use magnets for many hundred years. STAND is proud of being the first manufacturer to apply magnets to tools, and changes the habits of using tools."

All of STAND's output is exported to major international tool brands in the U.S., Europe, Japan and other countries, mainly based on original design manufacturer (ODM) basis. STAND also tries to sell directly to large-scale retailers in the U.S. and promotes its own brand products.

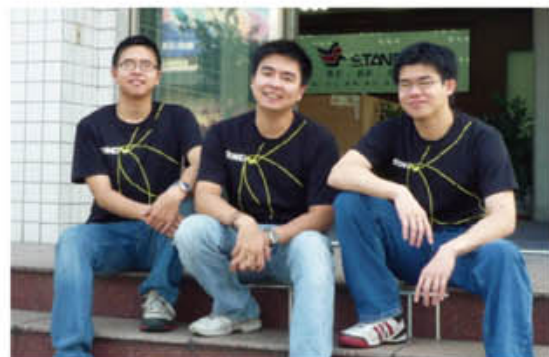

Awards

2001.10
The National
Invention
and Creation
Award



2005.10
The National
Invention and
Creation Award



2005.10
The 11th Small
and Medium
Enterprise
Innovation



2009.10
The 14th Small and
Medium Enterprise
Innovation



2010.07
Stand Tools Calibration
Laboratory established.
TAF & ilac-MRA
Combination Mark



2011.11
Stand Tools rewarded
the China Domestic
and Foreign Hardwares
Top 20 Award



2012.07
Stand Tools rewarded the
Golden Pin Design Award



Magnetic Holder

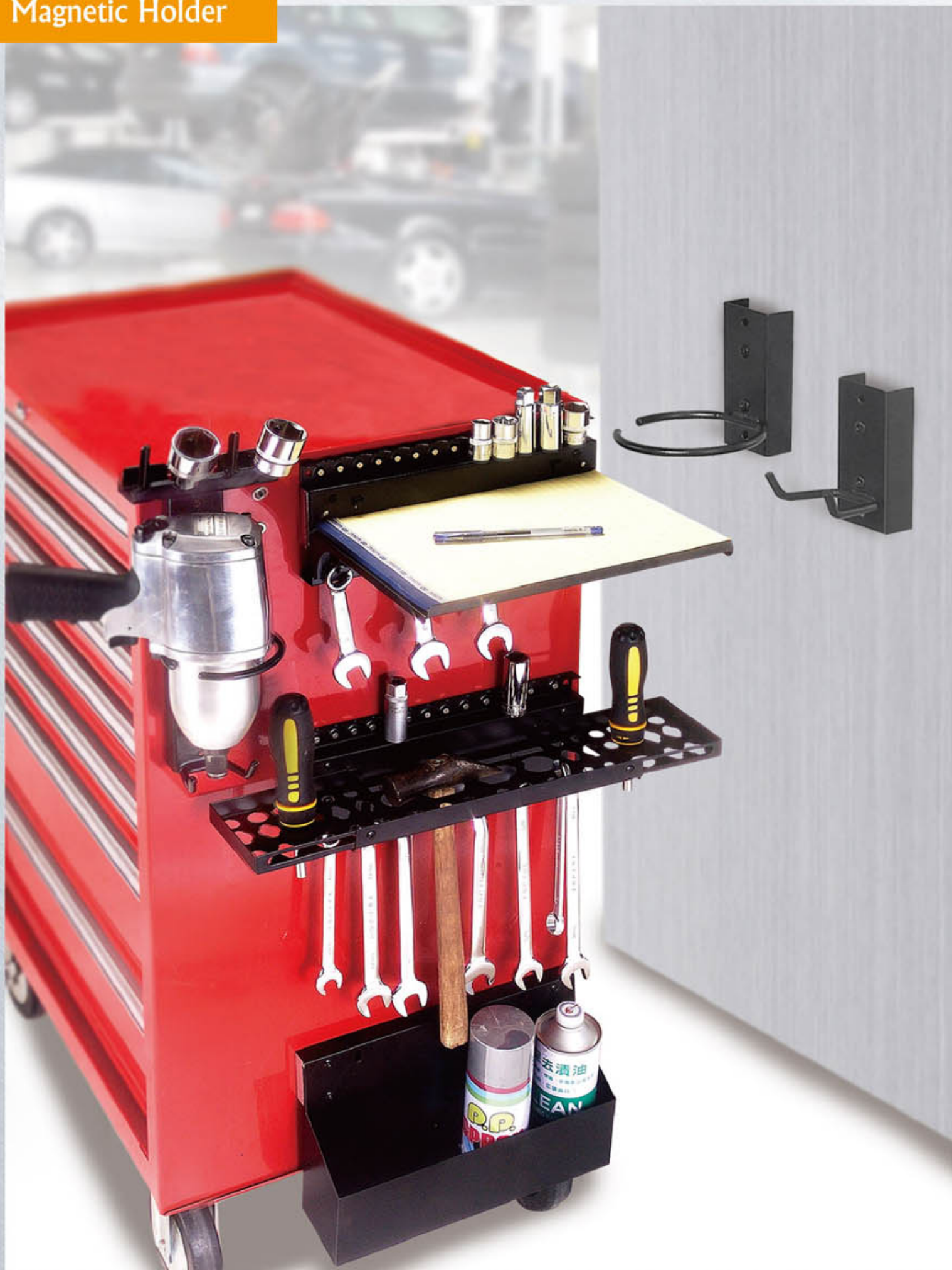

MAGNETIC TOOL HOLDER FOR IMPACT WRENCH

- This magnetic holder is designed for holding most pistol type impact wrenches and impact sockets.
- The magnetic holder can easily hold one impact wrench, four impact sockets, and other tools, i.e. screwdrivers.
- With PE or Power coating finish, this magnetic holder is environmental compliance.
- Enhance the load capacity (Two screws included).
- Wire hook organizes air hoses electric wires, or tools.
- Magnetic capacity can reach up to 33 Lbs attaching on 3 mm iron plate. Capacity can be influenced by the thickness and finish of attaching surface.

Model NO. 11050142

Length	Width	Height	Capacity
132mm/5-1/8"	350mm/13-4/5"	128mm/5"	15kgs/33lbs



Screw-hole design, screws the holder on nonferrous surface.



Special magnetic structure can firmly attach to ferric surface up to 15kgs.(33 lbs)

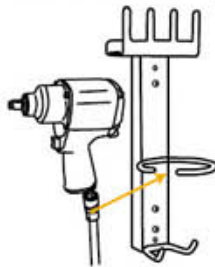

Special gap design
Easy to organize air hoses without barrier.



MAGNETIC HANGER

- Hold heavy tools (i.e. hammers, mallets, wrenches and etc.)
- Hold irregular-shape tools (i.e. tube, hose, pistol and etc.)
- Perfectly holds shovels, brooms, cords and rakes.
- Magnetic capacity can reach up to 20 Lbs attaching on 3 mm iron plate. Capacity can be influenced by the thickness and finish of attaching surface.



Model NO. 11050150

Length	Width	Height	Capacity
65mm/2-1/2"	100mm/4"	79mm/3-1/8"	9kgs/20lbs

MINI MAGNETIC IMPACT WRENCH HOLDER

- Special gap design easy to organize air hoses without barrier.
- Hold pistol type impact wrench.
- Magnetic capacity can reach up to 20 Lbs attaching on 3 mm iron plate. Capacity can be influenced by the thickness and finish of attaching surface.



Model NO. 11050151

Length	Width	Height	Capacity
106mm/4-3/16"	100mm/4"	128mm/5"	9kgs/20lbs

MULTI-FUNCTION MAGNETIC TOOL HOLDER

- Organize screwdrivers, sockets, wrenches, hammers, pliers and more in one place. (Hold up to 71 tools.)
- Keep tools neat and in reach.
- Easily extend width to 50cm (20") for more available space.
- Perfectly uses in garages, workshops and manufacturing sites.
- Removable and portable design can carry tools to anywhere you want at the same time.
- Magnetic capacity can reach up to 33 Lbs attaching on 3 mm iron plate. Capacity can be influenced by the thickness and finish of attaching surface.
- Enhance the local capacity (Two screws included).

Model NO. 11050147

Length	Width	Height	Capacity
310mm/12-1/4"	125mm/4-15/16"	128mm/5"	15kgs/33lbs



MAGNETIC TABLE

- Socket write to write down notes and testing reports, on the table.
- Magnetic seats can attract small items (i.e. sockets, bits, screws and etc.)
- Hooks hold wrenches, hammers and etc.
- Perfectly uses in garages, workshops, manufacturing sites and jobsites.
- Removable and portable design can carry tools to anywhere you want at the same time.
- Magnetic capacity can reach up to 33 Lbs attaching on 3 mm iron plate.
- Capacity can be influenced by the thickness and finish of attaching surface. Enhance the load capacity with screws.
- Enhance the local capacity (Two screws included).

Model NO. 11050156

Length	Width	Height	Capacity
310mm/12-1/4"	125mm/4-15/16"	240mm/9-7/16"	15kgs/33lbs



MAGNETIC TOOLS BOX

- Powder coating finish makes it durable.
- Angle outline design makes it easy to overlook inside.
- Chamfer design can hold various tools, i.e. cans, brushes, tapes and etc.
- Make tools & hardware handy and organized.
- Perfectly for use in garages, workshops, and manufacturing sites.
- Enhance the load capacity with screws. (2 screws included)
- Removable and portable design can carry tools to anywhere you want at the same time.
- Magnetic capacity can reach up to 33 Lbs attaching on 3 mm iron plate. Capacity can be influenced by the thickness and finish of attaching surface.
- Enhance the local capacity (Two screws included).

Model NO. 11050162

Length	Width	Height	Capacity
310mm/12-1/4"	190mm/7-1/2"	87mm/3-7/16"	15kgs/33lbs



Screw hole design can fix box on the wall for more capacity.



Attach to cabinet



For Garage/Factory



For Kitchen



Magnetic Holder



Each socket seat has one Neodymium magnet inside to attract sockets, bits, drills and etc.



Special holes design can hold lots of tools.



Special hooks can hold wrenches, keys, and other useful hand tools.



Floating-type magnet structure can firmly attach to cabinet or any ferric surface. Up to 33 lbs of pulling strength.

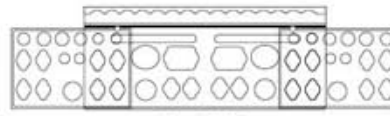

EXTEND

Easily extend the width to 50cm(20") for more available space.

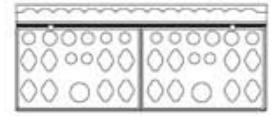

SHRINK

Two drawers can be shrunk into 31cm (12-1/4").



Each socket seat has one Neodymium magnet inside to attract sockets, bits, drills and etc.



Extra table function.



Special hooks can hold wrenches, keys, and other useful hand tools.



Attach to the cabinet



For factory



Screw hole design can fix table on the wall for more capacity.



Magnetic Sweeper & Finder



RELEASE MAGNETIC SWEEPER WITH WHEELS

- Release magnetic sweeper has a magnetic device which enables to attract any metal items and spare parts laying on the ground without picking them up one by one.
- Pull the trigger to release magnetic force.
- Easy to use, safe and practical time saving device.
- Permanent magnet.



RELEASE MAGNETIC RAKE

- Magnetic rake is perfect for picking up metal items from sand, grass and matchwood.
- Turn the knob to release magnetic force.
- Telescope rod extends from 675m/m to 1100m/m.

Model NO. 11050122		
Rod Size	Total Width	
675mm/26-1/2" ~ 1100mm/43-3/8"	377mm/14-1/2"	



Magnetic Sweeper & Finder

MINI EZ-RELEASE MAGNETIC PICK-UP TOOL

- Easy to pick up various kinds of hand tools, small iron and paper clips.
- Pull the trigger to drop attracted items easily.
- Permanent magnet.
- Light and handy design fits ergonomics.
- Impact-proof plastic materials.

Model NO. 11050107

Diameter Ø	Height
102mm/4"	180mm/7"



PICK UP METAL ITEMS



Workshop



Sawmill



Garage



Office

EZ-RELEASE MAGNETIC PICK-UP TOOL

- Pick up ferrous items such as screws, bolts, nails, and steel parts.
- Release attracted items by pulling the trigger on the handle.
- Easy to use, safe, practical and time saving.
- Permanent magnet.



Model NO. 11050229

Diameter Ø	Height
92mm/3-5/8"	1372mm/54"



Model NO. 11050087

Diameter Ø	Height
92mm/3-5/8"	680mm/26-3/4"



PICK UP METAL ITEMS



Sawmill



Workshop



Garage

POWER CLEAN UP MAGNETIC

- Quickly and safely to clean up sharp cuts like iron & steel chips and waste.
- Release iron filings by pulling the bar.
- Easy to pick and release scrap and ferrous debris.
- Light, non-rusting stainless steel shaft.

PICK-UP

RELEASE

PULL

Attract items and release them automatically by pulling the bar.



PICK UP METAL ITEMS

Model NO. 11050050

Height	Diameter Ø
390mm/15-3/8"	25mm/1"

Model NO. 11050223

Height	Diameter Ø
400mm/15-3/4"	11mm/7/8"



Workshop



Garage



Sawmill



Office

EZ-RELEASE MAGNETIC PICK-UP TOOL

- Pick up ferrous items such as screws, bolts, nails, and steel parts.
- Release attracted items by pulling the trigger on the handle.
- Easy to use, safe, practical and time saving.
- Permanent magnet.

Model NO. 11050054

Diameter Ø	Height
98mm/3-7/8"	960mm/37-3/4"

PICK-UP

RELEASE



PICK UP METAL ITEMS

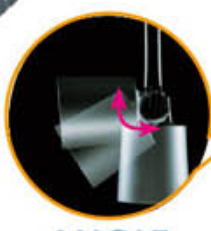

ANGLE

MAGNETIC FINDER

- Pick up ferrous items such as screws, bolts, nails, and steel parts.
- Release attracted items by pulling the trigger on the handle.
- Easy to use, safe, practical and time saving.
- Permanent magnet.

Model NO. 11050041

Diameter Ø	Height
90mm/3-1/2"	960mm/37-63/4"



PICK UP METAL ITEMS



TELESCOPE ROD



Magnetic Sweeper & Finder

RECTANGULAR MAGNETIC FINDER

- Powerful magnetic tool is ideal for picking up ferrous metal items such as iron chips, shavings, nails, nuts, and etc.
- Quick, convenient, safe, and time saving to clean floors, driveways, and construction areas.
- Adjustable angle design easily reaches under machinery or cars.
- Aluminum telescope rod.
- Ergonomic handle for comfort.

Model NO. 11050047

Rod Size

680mm/26"-3/4 ~ 1100mm/43-1/4"



RECTANGULAR MAGNETIC FINDER WITH WHEELS

- Powerful magnetic tool is ideal for picking up ferrous items such as iron chips, shavings, nails, nuts, and etc.
- Quick, convenient, safe, and time saving to clean floors, driveways, and construction areas.
- Adjustable angle design easily reaches under machinery or cars.
- Aluminum telescope rod.
- Ergonomic handle for comfort.
- Smart and convenient wheels design saves time and energy while cleaning up and removing stuffs

Model NO. 11050125

Rod Size

680mm/26"-3/4 ~ 1100mm/43-1/4"



TELESCOPE SECURITY MIRROR

- Adjustable, convex, 8" mirror has a 180° degree view angle
- Telescope aluminum rod, 660mm~1280mm, light to carry and grip
- Checking under vehicles or equipments at security checkpoints
- Security mirror helps to estimate blind spots
- Easy to use and storage in workplace
- Ergonomic handle for comfort

Model NO. 11120006

Rod Size

Diameter Ø

660mm/26" ~ 1280mm/50"

250mm/9-7/8"



Magnetic Rack

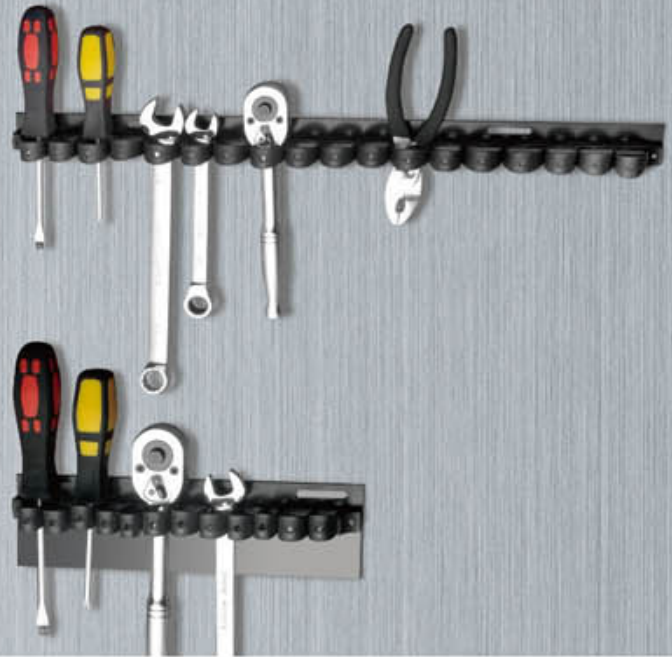

MAGNETIC TOOL HOLDER

- Powerful magnets hold and organize wrenches, sockets, and fasteners.
- Tools and fasteners can be secured when taken to the job site.
- Low profile holder fits in tool box, tool storage drawer, or can be hung on any metal surface.
- Take off easily with firm grip.

Model NO. 11050118

Length	Width	Height
305mm/12"	50mm/2"	7mm/1/4"

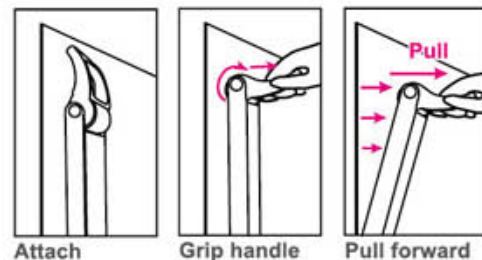

PAD



Attach to the cabinet



Office/Home



Garage

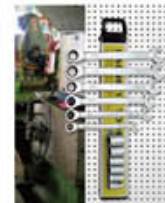

Workshop



470mm MAGNETIC TOOL HOLDER

- Powerful 1000 ~ 1200 gauss permanent magnets.
- Hold all kinds of metal tools and stuffs.
- Attach to metal surface or fix on the wall with screws included.

Model NO. 11050108

Length	Width	Height
471mm/18-1/2"	24mm/15/16"	24mm/15/16"



Attach to metal surface



Mount easily on the wall with screws included



Workshop



Garage



Magnetic Rack

20" MAGNETIC RACK

- Hold all kinds of tools and metal stuffs.
- Leave workspace free, mount easily on the wall with screws included.
- Modular mounting brackets allow you to conjoin the rack one by one.
- Powerful permanent magnet.

Model NO. 11050091

Length	Width	Height
510mm/20"	30mm/1-1/8"	27mm/1-1/16"



Non-ferrous tools or items can be placed between the rack and the wall



Office/Home



Workshop



Garage

Allows you to conjoin the rack one by one

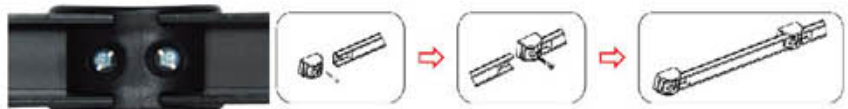

Modular mounting brackets allow you to conjoin the rack one by one

ABS MAGNETIC HOLDER

- Hold all kinds of metal tools.
- Mount on the wall with screws included..

Model NO. 11050025

Length	Width	Height
475mm/17-15/16"	51mm/2"	17mm/11/16"



Workshop



Garage



STONG MAGNETIC HOLDER

- Hold all kinds of metal tools.
- Mount on the wall with screws included..

Model NO. 11050056

Length	Width	Height
364mm/14-3/8"	50mm/2"	35mm/1-3/8"



Home/Office



Sawmill



Magnetic Rack

MULTI-CLIP MAGNETIC HOLDER

- Tools can be held firmly between clips, or plugged in holes.
- One hand use. Easy to clip on and take off tools.
- Holds ferrious or non-ferrious tools.
- Total 12 or 19 pcs of clips.
- Enhance the load capacity with screws.
- Attached on any metal surface.

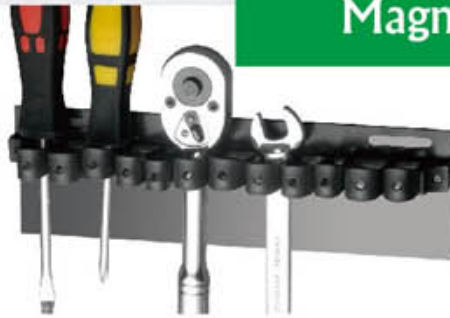

230mm

Model NO. 11110005

Length	Width	Height
230mm/9"	38mm/1-1/2"	41mm/1-5/8"

MULTI-CLIP TOOL HOLDER

- Tools can be held firmly between clips, or plugged in holes.
- One hand use. Easy to clip on and take off tools.
- Holds ferrious or non-ferrious tools.
- Total 12 or 19 pcs of clips.
- Enhance the load capacity with screws.



230mm

Model NO. 11110002

Length	Width	Height
230mm/9"	38mm/1-1/2"	30mm/1-1/8"



500mm

Model NO. 11110004

Length	Width	Height
500mm/19-11/16"	38mm/1-1/2"	30mm/1-1/8"

MEMO

Magnetic Tray

- Heavy duty 1000 ~ 1200 gauss permanent magnets.
- Rubber coating prevents scuffing and scratching valuable surface.
- Stainless steel tray resists corrosion.
- It can be used horizontally, vertically, and upside down.
- It is convenient to collecting small parts and tools.

ROUND MAGNETIC TRAY



Collector



Holds to metal



Upside down

Model NO. 11050070

Diameter Ø	Depth
110mm/4-1/4"	20mm/7/8"

ROUND MAGNETIC TRAY



Collector



Holds to metal



Upside down

Model NO. 11050023

Diameter Ø	Depth
150mm/5-1/8"	30mm/7/16"

SQUARE MAGNETIC TRAY



Collector



Holds to metal

Model NO. 11050084

Length	Width	Height
293mm/11-1/2"	272mm/10-5/8"	37mm/1-7/16"



RECTANGULAR MAGNETIC TRAY



Collector



Holds to metal



Upside down

Model NO. 11050029

Length	Width	Height
242mm/9-1/2"	142mm/5-5/8"	37mm/1-7/16"

TRIPLE MAGNETIC TRAY



Collector



Holds to metal



Upside down



Model NO. 11050085

Length	Width	Height
360mm/14-1/8"	160mm/1-1/4"	37mm/1-7/16"

ROUND MAGNETIC STRAINER



Collector



Model NO. 11050082

Diameter Ø	Depth
280mm/11"	100mm/4"

MULTI-CLIP MAGNETIC HOLDER

- Hinged parts swivel for accurate position.
- Aluminum flashlight with switch on the button.
- All parts are exchangeable and can be used together or separately depending on your needs.
- Super bright LED illuminate confined areas.
- Shatter proof inspection mirror.
- Magnet dia. is only 18mm (0.71") can pick up items in hard to reach place.
- Magnet head-shield prevents magnet from attracting unwanted items.
- 3. extension styles; Flex Extender, Bended extender, and Straight extender.
- 2 bulbs: 1-UV light; 1-0.5w LED light.
- Organize and store all items in one zipper pouch.

Model NO. 11100009

Contents

- Aluminium Interchangeable Handle
- Inspection Mirror
- 6 lbs Magnetic retriever
- 10" flexible extender
- 9" 135 degree bended extender
- 8" straight extender
- UV light
- LED light



Mirror + Light

Magnet

Inspect parts in dark place by mirror & LED light

Attract small parts in dark place by magnet & LED light

Pick up metal objects in hard to reach places

Detect radiator leak with UV light

LIGHTED PICK-UP TOOL WITH MIRROR SET

Model NO. 11050188

Contents

- LED Lighted Telescope & 1 Lb Magnet tool, PVC handle, 6 sections, 160mm~665mm
- 1-8 Lbs Telescope Magnet tool, PVC handle, 6 sections, 150mm~665mm
- 3-Inspection mirrors, Ø21mm/Ø31mm/Ø38mm



LED Light & Magnet

LED Light & Mirror

LED Light and Mirror with Magnet

1 Lb Magnet

8 Lbs Magnet

LED Light



MAGNETIC PICK-UP TOOL & INSPECTION MIRROR SET

Model NO. 00220076

Contents

- 1-Telescope inspection mirror, 225~710mm
- 1-Stainless steel tube, 5 sections, 170~654 mm
- 1-black zipper case
- 3-interchangeable magnets, 1LB/8LB/8LB flexible



8 Lbs Magnet



Allows visual inspection in confined areas.

4-IN-1 LIGHTED MAGNETIC RETRIEVER

Model NO. 00130063

Contents

- 1-Telescope tool w/pen or pin, 7 sections, 135~630mm
- 1-Lighted cap w/ 1 Lb magnet
- 1-1 Lb magnetic cap
- 1-Flexible Inspection Mirror



MINI WORKING LAMP FLEXIBLE & MAGNETIC

- Combine 4 useful functions in 1 unit:
- LED Light.
- Flexible Tube→Fix the angle accuracy.
- Powerful Magnet→Retrieve items in tight areas.
- Magnetic Stand→Attach firmly.

Model NO. 11050173

Length

480mm/15-3/4"



Pick up metal objects in hard to reach places

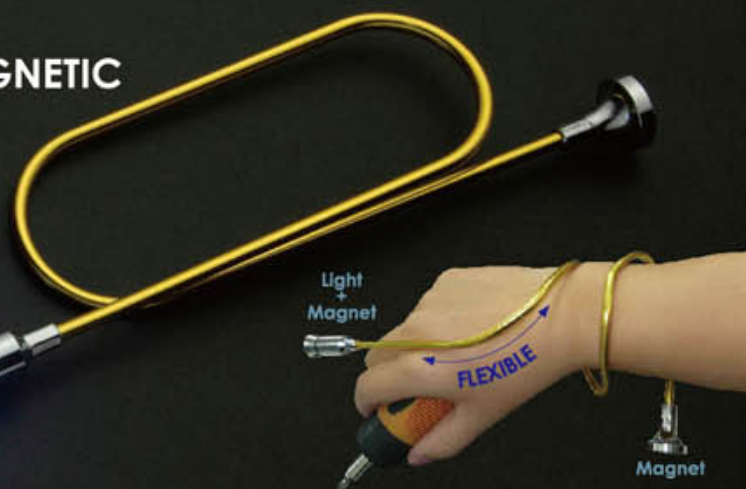

TELESCOPE INSPECTION MIRROR with LIGHT

Model NO. 00330003

Contents

- 1-lighted telescope tool, 2 section, 140 ~ 240mm
- 1-inspection mirror



LED MAGNETIC TELESCOPE PICK-UP with PIN

Model NO. 11050160

Length

Sections

Capacity

170mm/16-16/11" ~ 670mm/26-3/8"

7

1lb

Model NO. 11050175

Length

Sections

Capacity

170mm/7-1/2" ~ 693mm/27-1/4"

6

1lb

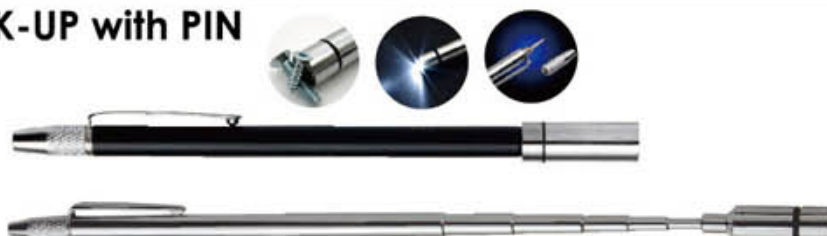

LED MAGNETIC TELESCOPE PICK-UP

Model NO. 00130218

Length

Sections

Capacity

280mm/11" ~ 609mm/24"

5

2kgs/4.5lbs

Model NO. 11050182

Length

Sections

Capacity

160mm/6-1/4" ~ 675mm/26-1/2"

6

1lb



RECTANGULAR MIRROR

Model NO. 01160003

Length

Sections

Mirror

280mm/11" ~ 390mm/15-2/8"

2

89mm/3-1/2" X 54mm/2-1/8"



TELESCOPE & SWIVEL INSPECTION MIRROR

Model NO. 01160002

Length

Sections

Mirror Ø

250mm/9-13/16" ~ 840mm/13-1/8"

6

57mm/2-1/4"

Model NO. 12050002

Length

Sections

Mirror Ø

295mm/11-1/2" ~ 453mm/17-3/4"

2

52mm/2"

Model NO. 12050026

Length

Sections

Mirror Ø

185mm/7-7/16" ~ 553mm/21-3/4"

6

32mm/1-1/4"

Model NO. 12050025

Length

Sections

Mirror Ø

180mm/7-1/16" ~ 530mm/21-1/8"

6

32mm/1-1/4"



MAGNETIC TELESCOPE PICK-UP

Model NO. 11050176			
Length	Sections	Capacity	
150mm/5-7/8" ~ 665mm/25-3/4"	6	3.6kgs/8lbs	
Model NO. 11050073			
Length	Sections	Capacity	
170mm/5-5/8" ~ 900mm/29-3/4"	7	3.6kgs/8lbs	
Model NO. 11050124			
Length	Sections	Capacity	
165mm/6-1/2" ~ 645mm/25-7/16"	5	3.6kgs/8lbs	
Model NO. 11050209			
Length	Sections	Capacity	
160mm/6-1/4" ~ 670mm/26-3/8"	6	1lb	
Model NO. 11050015			
Length	Sections	Capacity	
120mm/4-3/4" ~ 635mm/25"	7	1lb	
Model NO. 11050216			
Length	Sections	Capacity	
128mm/5-1/8" ~ 640mm/25-4/8"	6	1lb	
Model NO. 12050004			
Length	Sections	Capacity	
150mm/5-7/8" ~ 650mm/25-3/4"	7	1lb	
Model NO. 12050001			
Length	Sections	Capacity	
130mm/4-3/8" ~ 629mm/20-3/4"	7	1.3kgs/3lbs	
Model NO. 11050017			
Length	Sections	Capacity	
130mm/5-1/8" ~ 629mm/23-3/4"	7	2.9kgs/6.5lbs	
Model NO. 11050002			
Length	Sections	Capacity	
160mm/6-1/4" ~ 530mm/20-7/8"	6	1lb	
Model NO. 12050029			
Length	Sections	Capacity	
170mm/5-5/8" ~ 775mm/30-1/2"	7	3.6kgs/8lbs	
Model NO. 12050027			
Length	Sections	Capacity	
170mm/5-5/8" ~ 885mm/34-7/8"	7	1kgs/2lbs	



POCKET BACK SCRATCHER

Model NO. 11110001		
Length	Sections	
170mm/6-5/8" ~ 670mm/26-3/8"	6	
Model NO. 11110009		
Length	Sections	
210mm/8-1/4" ~ 690mm / 27-1/4"	5	



SHOEHORN

Model NO. 11110009		
Length	Sections	
360mm/13" ~ 635mm/26"	3	



Inspection Tool

LED ALUMINUM FLASHLIGHT

Model NO. 11100014

Length

140mm/5-1/2"



PLASTIC INSPECTION MIRROR

Model NO. 00220426

Length Mirror Size

240mm/9-7/16" Ø24mm/15/16"



ALUMINUM TUBE

Model NO. 31320045

Length

130mm/5-1/8"



ROUND SWIVEL TELESCOPING TOOL

Model NO. 12050024

Length Sections

150mm/5-7/8" ~ 645mm/25-1/8"

7



ROUND MIRROR



Model NO. 2110026

Length Mirror Size

62mm/1-1/4" Ø30mm/1-1/8"



Model NO. 2110028

Length Mirror Size

90mm/3-1/2" Ø30mm/1-1/8"



(MAGNIFY)

Model NO. 21110007

Length Mirror Size

150mm/5-7/8" Ø24mm/15/16"

OVAL TELESCOPING TOOL

Model NO. 12050023

Length Sections

180mm/7-1/8" ~ 625mm/25-1/8"

5



MAGNETIC LED LIGHT HEAD



Model NO. 21050052

Length Capacity

38mm/1-1/2" 1lb

MAGNETIC HEAD



Model NO. 21050053

Length Capacity

20mm/3/4" 3.6kg/8lbs

RECTANGULAR MIRROR



Model NO. 21100022

L x W Length

65mm/2-9/16" X 43mm/1-11/16" 96mm/3-13/16"

(STAINLESS)



Model NO. 21100019

L x W Length

65mm/2-9/16" X 43mm/1-11/16" 96mm/3-13/16"

ROUND MIRROR



Model NO. 21100017

Length Mirror Size

90mm/3-9/16" Ø60mm/2-3/8"



(MAGNIFY)

Model NO. 21100015

Length Mirror Size

87mm/3-7/16" Ø55mm/2-1/8"



Model NO. 21100013

Length Mirror Size

80mm/3-1/8" Ø50mm/1-15/16"



Model NO. 21100011

Length Mirror Size

72mm/2-15/16" Ø40mm/1-9/16"



Model NO. 2110004

Length Mirror Size

62mm/2-7/16" Ø30mm/1/8"



Model NO. 2110009

Length Mirror Size

58mm/2-1/4" Ø24mm/15/16"



Model NO. 21100029

Length Mirror Size

45mm/1-3/4" Ø14mm/7/16"

HIGHTED FLEXIBLE MAGNETIC PICK UP TOOL

Model NO. 11050218

Length Capacity
610mm/24" 1lb



Mirror Optional



Model NO. 11050230

Length Capacity
620mm/24-6/8" 1lb



Model NO. 11050057

Length Capacity
530mm/20-7/8" 0.3kgs/0.7lb



FLEXIBLE MAGNETIC PICK UP TOOL

Model NO. 11050139

Length Capacity
490mm/19" 1.8kgs/4lbs



Model NO. 11050225

Length Capacity
540mm/21-3/4" 0.3kgs/0.7lb



Model NO. 11050001

Length Capacity
553mm/21" 12kgs/26.6lbs



Model NO. 11050195

Length Capacity
553mm/21" 12kgs/26.6lbs



CLAW PICK-UP TOOL

Model NO. 11090032

Length
165mm/5-1/4"



Model NO. 11090025

Length
558mm/22"



Model NO. 11110015

Length
550mm/21-11/16"



LED LIGHT CLAW PICK-UP TOOL

Model NO. 11110010

Length
514mm/20-1/4"



Other Magnetic Tools

MAGNETIC CANE HOOK

- Hook for holding stuffs.
- Useful for garage, office, kitchen, bathroom, and laundry.
- Attach to metal surface to hold keys, bags, towels, cooking ladles, laundry bags
- Versatile for shop, office school and home.
- Great for hanging tools, utensils, accessories and more.

Model NO. 11050158

Length	Width	Height	Capacity
25mm/1"	70mm/2-3/4"	22mm/7/8"	3.6kgs/8lbs



MAGNETIC QUESTION HOOK

- Hook for holding stuffs.
- Useful for garage, office, kitchen, bathroom, and laundry.
- Attach to metal surface to hold keys, bags, towels, cooking ladles, laundry bags.
- Perfect for hanging a drop light underneath an auto hood, as well as keys, tools and more.

Model NO. 11050159

Length	Width	Height	Capacity
25mm/1"	25mm/1"	43mm/1-11/16"	5kgs/11lbs



MAGNETIC KEYCHAIN

- Key ring design can connect to any hole-shape products.
- Attach to metal surface to hold keys, bags.
- Versatile and useful for home, office and factory.

Model NO. 11050157

Length	Width	Height	Capacity
8mm/5/16"	8mm/5/16"	32mm/1-1/4"	1kgs/2lbs



MAGNETIZER & DEMAGNETIZER

- To magnetize, insert tip of screwdriver into hole of magnetizer.
- To demagnetize, rub tip of screwdriver along slot on top of demagnetizer until completely demagnetized.



Magnetize



Pick up



Demagnetize



Model NO. 11050115

Length	Width	Height
80mm/3-1/8"	25mm/1"	10mm/3/8"



Magnetize



Pick up



Demagnetize



Model NO. 11050053

Length	Width	Height
25mm/1"	25mm/1"	25mm/1"

MAGNETIC HOLDER

- Key ring design can connect to any hole-shape products.
- Attach to metal surface to hold keys, bags.
- Versatile and useful for home, office and factory.

Model NO. 11050048

Length	Width
300mm/11-13/16"	60mm/2-3/8"



It's easy to pick-up magnetic particles



Excellent for fastener and small parts

MINI POWER CLEAN UP WORK MAGNET

- Quickly and safely to clean up sharp cuts like iron & steel chips and waste.
- Release iron filings by pulling the bar.
- Easy to pick and release scraps and ferrous debris.
- Light, non-rusting shaft.

Model NO. 00260093

Length	Width	Height
138mm/5-7/16"	20mm/3/4"	8mm/5/16"



Office/Home



MAGNETIC BELT CLIP

- Provide a safe and convenient place to keep your fasteners and small tools handy.
- Never hold nails into your mouth again.
- Prevent dropping tools and fasteners.



Attract nails, screws etc.



Model NO. 11050097

Length	DiameterØ
60mm/2-3/8"	41mm/1-5/8"



Model NO. 11050098

Length	DiameterØ
40mm/1-9/16"	29mm/1-1/8"

EASY HITCH ALIGNMENT WAND SET

- This light-up, telescoping magnetic device can be utilized universally.
- Use the flashing light, as a magnetic pick up through tight spaces, or even water.

Model NO. 11050044

Length	Section
210mm/8-1/4" ~ 940mm/37"	8

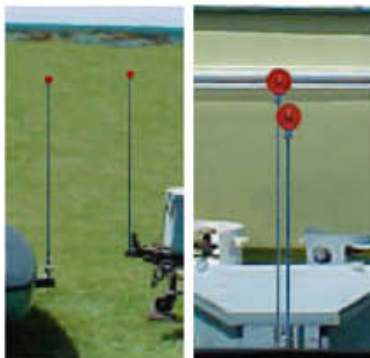

This device can help the driver to connect the vehicle with the car easily. Extend the rods, turn on the flashing light, watch the rear mirror, and move back slowly, when the ball knock the lob, it is time to remote the hitch.



MAGNET

MAGNETIZER FLASHLIGHT

- LED flashlight with magnet.
- Attached on bicycles or vehicles to attract other's attention.

Model NO. 11050180

Length	Width	Height
30mm/1-3/16"	25mm/1"	55mm/2-3/8"



STUD FINDER

- Clear base for better visibility.
- Pencil holes on base to mark location
- Plunger JUMPS when pass over fasteners.

Model NO. 11050069

Length	Width	Height
35mm/1-3/8"	35mm/1-3/8"	45mm/1-3/4"



Clear base for better visibility.



Easy to find the stud



Plunger JUMPS when passed over fasteners.

Other Magnetic Tools

MAGNETIC QUICK CLAMP

- Design to enable fast and accurate to hold ferrous metals for welding and assembly jobs.
- It holds both sheets and tubes at angles of 180°, 90°, 75°, 60°, 45° and 30°.
- Body holes enable the clamp to be built into jigs or hung up when not in use.

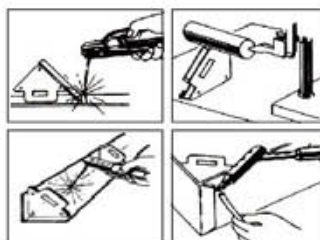

Model NO. 11110006

Length	Width	Height
95mm/3-3/4"	64mm/2-1/2"	14mm/9/16"



Model NO. 12050009-XL

Length	Width	Height
202mm/8"	128mm/5"	21mm/13/16"



Model NO. 12050009-L

Length	Width	Height
158mm/6-1/4"	102mm/4"	19mm/3/4"



Model NO. 12050009-M

Length	Width	Height
120mm/4-3/4"	82mm/3-1/4"	14mm/9/16"

MAGNETIC QUICK CLAMP

- Equipped with a spring-loaded brass electrode, the magnetic ground clamps attach securely direct to work surface.
- Heavy-duty steel housing holds a powerful magnet for fast, yet safe ground.
- Ground wire will rotate 360° for easy access.

Model NO. 12050011

DiameterØ	Height
49mm/1-15/16"	40mm/1-9/16"



Model NO. 12050010

DiameterØ	Height
70mm/2-3/4"	52mm/2"

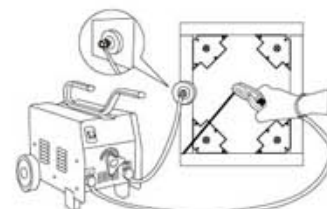

MULTI-FUNCTION PERMANENT MAGNET

- Magnetic force over wide influence.
- To avoid birds' damage of fruits and vegetables by disturbing their direction. (50cm away from fruits or vegetables).
- Multi-function for home, warehouse, office, garage and etc, like holding light when repairing under the car.

Model NO. 31410090

External Diameter	Insidel Diameter	Height
Ø80mm/3-1/8"	Ø40mm/1-9/16"	12mm/1/2"



POWER MAGNET

- Heavy duty 1000 ~ 1200 gauss permanent magnets.
- 3000 gauss rare earth Nd-Fe-B.



Model NO. 00230142-12pcs

DiameterØ	Height
6.18mm	3mm



Model NO. 00230143-10pcs

DiameterØ	Height
8mm	2mm



Model NO. 00230144-6pcs

DiameterØ	Height
10mm	4mm



Model NO. 00230145-6pcs

DiameterØ	Height
13mm	2mm



Model NO. 00230146-1pcs

DiameterØ	Height
22mm	8mm



Model NO. 00230147-4pcs

Length	Width	Height
40mm	25mm	10mm



Model NO. 00230148-4pcs

Length	Width	Height
50mm	18mm	10mm



Model NO. 00230149-1pcs

External Diameter	Insidel Diameter	Height
Ø80mm	Ø40mm	12mm

Tool Set



POCKET TOOLS SET

- 36 teeth ratchet
- Slim body shape can reach any confined area.
- Different sizes of bits. They match users' various needs.
- Fasten sockets with 1 adapter included.
- Ratchet function saves time and labor.
- Two directions available. Either to fasten or loose the screws.



1/4 Ratchet Wrench

Model NO. 11060047



3/8 Ratchet Wrench

Model NO. 11060048



Bits Set

Model NO. 00150027

Contents:

- 1-PP Box
- 1-AD
- 1-Ratchet Wrench
- 11-Bits

Size:

Length: 60mm/2-3/8"
Width: 137mm/5-3/8"
Height: 19mm/3/4"



Bits & Socket Set

Model NO. 00150034

Contents:

- 1-PP Box
- 1-AD
- 1-Ratchet Wrench
- 1-Bit Holder
- 4-Sockets
- 6-Bits

Size:

Length: 60mm/2-3/8"
Width: 137mm/5-3/8"
Height: 19mm/3/4"

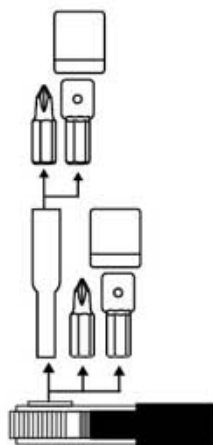

Precision Set

Model NO. 00150038

Contents:

- 1-PP Box
- 1-Precision Screwdriver
- 1-Extension Holder
- 16-Bits

Size:

Length: 60mm/2-3/8"
Width: 137mm/5-3/8"
Height: 19mm/3/4"



ULTRA THIN Ratchet Wrench

- Torque: 120 kgf/cm / Thickness: 4.8mm
- 2-way ratchet function.
- The world most thin ratchet wrench.
- The unique shape and elegant package to attract client eyes.
- It is durable and simple to use.

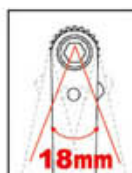
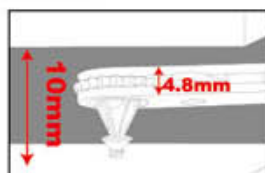

• Tiny and slim design makes user easily work in a confined area

• 20-teeth ratchet function

• 4 bits or 8 bits available

• Small size

4.8m/m

Model NO. 00150047

Contents:

- 1-PP Box
- 1-Ratchet Wrench
- 4-Bits

Size:

Length: 53mm/2-1/16"
Width: 128mm/5"
Height: 10mm/3/8"



6.5m/m

Model NO. 00150055

Contents:

- 1-PP Box
- 1-Ratchet Wrench
- 8-Bits

Size:

Length: 53mm/2-1/16"
Width: 128mm/5"
Height: 10mm/3/8"



7.2m/m ULTRA THIN Ratchet Wrench

- Torque: 120 kgf/cm / Thickness: 4.8m/m
- 2-way ratchet function.
- The world most thin ratchet wrench.
- The unique shape and elegant package to attract client eyes.
- It is durable and simple to use.
- Often-used bits are included.



Model NO. 11060097

Contents:

- 1-Ratchet Wrench
- 4-Bits

Size:

Diameter: 25mm/1 1/16"
Height: 163mm/6-3/8"



3 WAY RATCHET SPINNER

- Patented ratchet design makes the work easier. (Left, Stop, Right)
- Ideal for getting into tight places.
- Bi-usage. One side is for bits; the other is for sockets.
- Built-in magnet can attract bits firmly.
- The opposite side is a 1/4" driver for sockets.
- Delicate design, light and easy to carry.

Model NO. 00130170

Contents:

- 1-Ratchet Wrench
- 3-30mm Double & Bit

Size:

Diameter: 35mm/1-1/38"
Height: 30mm/1-1/8"



POCKET RATCHET SCREWDRIVER

- Light & small
- Changeable bits

Model NO. 11010301

Contents:

- 1-Ratchet Wrench
- 1-Bit



6-IN-1 STUBBY GEARLESS RATCHET SCREWDRIVER

- Include 6 bits in an assortment of useful sizes!
- Meet ANSI
- Roller style of bearing construction

Model NO. 11010256

Contents:

- 1-Ratchet Wrench
- 6-Bit



4-IN-1 STUBBY RATCHET SCREWDRIVER

- High torque
- Ergonomic comfort grip
- Storage handle

Model NO. 11010300

Contents:

- 1-Ratchet Wrench
- 4-Bit



4-IN-1 STUBBY ANGLE RATCHET SCREWDRIVER

- High torque
- Ergonomic comfort grip
- Ratcheting driver angles to allow better control & access to confined areas

Model NO. 11010353

Contents:

- 1-Ratchet Wrench
- 4-Bit



REVOLVER SCREWDRIVER

- Cylinder type bits holder; bits hidden design
- Changeable cylinder(bits holder)
- Each cylinder contains 5 bits.
- Pull downward the handle; press the button to take out the cylinder.
- Pull downward the handle;then bits can be changed easily by rolling the cylinder.
- Bit sizes printed on the cylinder, and you can choose desired.

Model NO. 11030202

Contents:

- 1-Driver Handle
- 2-Bit Holder
- 10-Bits

How to change cylinder



1. Pull Handle Down
2. Press Button
3. Push cylinder upward



Change bit easy as 1, 2, 3 steps.



Pull Handle Down

Dial Cylinder to desired bit

...And Load

Model NO. 11030244

Contents:

- 1-Driver Handle
- 2-Bit Holder
- 10-Bits



Storage Handle

How to change cylinder



1. Pull Handle Down
2. Press Button
3. Push cylinder upward.



16-IN-1 3 WAY RATCHET SCREWDRIVER

- Ratchet screwdriver locks at 120° or straight to allow better control, more options and better access to reach confined areas.

Model NO. 11010359

Contents:

- 1-Ratchet Screwdriver
- 16-Bits



Include 16 bits in an assortment

Change degree by 3 steps



Move the red button down and hold it



Rotate the ratchet head



Release the red button and lock to specific direction



RATCHET WRENCH SET

21PCS SET

Model NO. 00130208

Contents:

- 1-Ratchet Wrench
- 1-Disc
- 1-Socket Holder
- 9-Sockets
- 1-Bits Holder
- 10-Bits



multi-funtion
ratchetwrench



1/4" DRIVER SOCKET & MAGNET TRAY SET

- 150mm (Φ5-3/4") magnetic tray
- Great for collecting small items, parts, and fasteners.
- Multi-function wrench can be applied with bits and sockets.
- Often-used sockets and bits are included.



Durable rubber foot
prevents damage to
valuable surfaces



Holds to metal



Collecto



Upside down

35PCS SET

Model NO. 00220077

Contents:

- 1-Magnetic Tray
- 1-Ratchet Wrench
- 1-ADAP
- 1-Disc
- 1-Socket Holder
- 1-Socket Extension
- 9-Sockets
- 21-Bits

Size:

DiameterØ: 150mm/5-1/8"
Height: 30mm/1-1/8"



20PCS SET

Model NO. 00210022

Contents:

- 1-Magnetic Tray
- 1-Ratchet Wrench
- 1-ADAP
- 1-Disc
- 1-Socket Extension
- 5-Sockets
- 9-Bits
- 1-Bit Holder

Size:

DiameterØ: 150mm/5-1/8"
Height: 30mm/1-1/8"



24 PC. GEARLESS SCREWDRIVER & BITS

Model NO. 00110085

Contents:

- 1-Gearless Screwdriver
- 1-Aapter
- 22-Bits



23 PC. FLEX DRIVER RATCHETING BITDRIVER SER

Model NO. 00110084

Contents:

- 1-Angle Ratchet Screwdriver
- 2-Bits Holder
- 20-Bits



50 PC. DELUXE RATCHET, BIT & SOCKET SET

Model NO. 00110046

Contents:

- 1-Ratchet Screwdriver
- 30-Bits
- 12-Sockets
- 7-Holders



HIGH TORQUE RATCHET SCREWDRIVER with 6 BITS

- High torque
- Ergonomic comfort grip
- Storage handle

Model NO. 11010024

Contents:

- 1-Ratchet Screwdriver
- 6-Bits



Tool Set

HIGH TORQUE RATCHET SCREWDRIVER with 6 bits

- High torque
- Ergonomic comfort grip

Model NO. 11020056

Contents:

- 1-Ratchet Screwdriver
- 6-Bits



RATCHET WRENCH

Model NO. 11060013



7-IN-1 RATCHET SCREWDRIVER & BITS

Model NO. 11010440

Contents:

- 1-Ratchet Screwdriver
- 4-Bits



T-SHAPE RATCHET SCREWDRIVER

Model NO. 11010380

Contents:

- 1-Ratchet Screwdriver
- 4-Bits



4-IN-1 QUICK CHANGE SCREWDRIVER

Model NO. 11020220

Contents:

- 1-PP Screwdriver Handle
- 2-75mm Double end Bits
- 4-1/2" Inter changeable Shaft with 5/16" Nut Driver



6-IN-1 QUICK CHANGE SCREWDRIVER

Model NO. 11020219

Contents:

- 1-PP Screwdriver Handle
- 2-75mm Double end Bits
- 4-1/2" Inter changeable Shaft with 1/4 & 5/16" Nut Driver



6 PC. PRECISION SCREWDRIVER SET

Model NO. 00150008

Contents:

- 6-Precision Screwdriver
- 1-Case



LIGHTED 9 PC. PRECISION SCREWDRIVER SET

Model NO. 00130059

Contents:

- 1-Light Handle
- 8-Interchangeable Bladed
- 1-Case



ANGLE DRIVER

Angle driver is designed for power driving in hard to reach places not easily accessed by conventional screwdrivers.



Model NO. 00130145

- Contents:**
- 1-Angle Driver
 - 1-Black Handle
 - 6-Bits



Model NO. 00130140

- Contents:**
- 1-Angle Driver



Model NO. 00130144

- Contents:**
- 1-Angle Driver
 - 1-Black Handle
 - 10-Bits



Model NO. 00120153

- Contents:**
- 1-Angle Driver
 - 1-Driver Handle
 - 1-Bit Holder
 - 10-Bits



Speed Chuck

36" FLEXIBLE DRILL SHAFT

- 36" long flexible drill shaft allows you to work in tight areas where a normal drill won't allow.
- Add a new level of versatility to your project capabilities with fingertip control for minor drilling, polishing, wood carving, sanding, engraving or grinding jobs.
- With 6mm shaft end fits into the chuck on your rotary tools.
- Integrated 1/4" chuck, accepts up to 6.35mm (1/4") shank accessories.
- Two reciprocating spiral springs, one inside the other, transmit the mechanical energy to the chuck.
- Each end has a strain relief sleeve to avoid twisting or bending of shaft.

Model NO. 00130080

Contents:

- 1-36" Flexible Drill Shaft

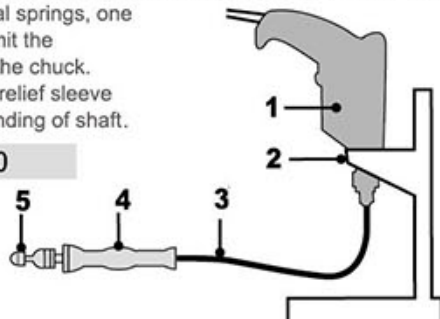

Flexible drill shaft

1. Drill
2. Drill stand
3. Flexible shaft
4. Handle bar with drill chuck
5. Accessory



SNAP OUT KEYLESS CHUCK

- A three-jaw keyless pin chuck.
- The shank of the chuck is 1/4" hexagonal.
- Applied with most drills and cordless screwdrivers.

Model NO. 11090002

Material: Zinc
Finish: Chrome plated
Max. grip dia: 1/4" (6.35mm)



Model NO. 11090003

Material: Steel
Finish: Black oxidizing
Max. grip dia: 1/4" (6.35mm)



Model NO. 11090001

Material: Steel
Finish: Chrome plated
Max. grip dia: 1/8" (3.175mm)



Model NO. 11090009

Material: Steel
Finish: Black oxidizing
Max. grip dia: 1/8" (3.175mm)



Other Tool

FUNNEL WITH STAINLESS FLEXIBLE TUBE AND FILTER

- User can transfer the fuel from the container to another.
- The detachable, flexible extension enables users to fill up any car with awkward positioned fuel tanks.
- The handle and filter are included. Protect hands and containers.

Model NO. 11140004



OIL FILTER WRENCH WITH SPRING BELT

- It is used for fastening or taking out the oil filter on the car.
- The length of spring belt can be changed.
- It is easily to replace the spring belt.

Model NO. 11090039

spring belt size:
12mm x 380 mm

Model NO. 11090040

spring belt size:
12mm x 530 mm



Ratchets

21010177 (Square Hole)



21010178 (Hex Hole)



21010176



21010175



21010102



21010101



21010025 (Iron)

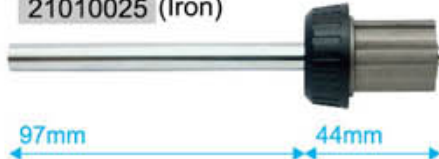

21010159 (Aluminum)

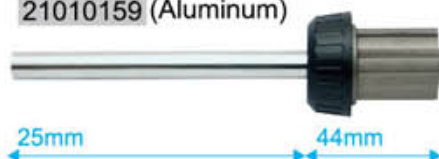

21010143



21010144



21010001



21010041



21010002



21010005



21010004



21010010



21010027





STAND TOOLS ENTERPRISE CO., LTD

No. 55, Cheng Feng Lane, Tai Ming Rd., Wu Jih, Taichung,
Taiwan 41468

T 886-4-2335 6489

E stand@ms19.hinet.net

F 886-4-2335 6491



www.standtools.com