

KITCHEN SCISSOR

- Raw material: 420J2
- Grip material: ABS
- Finishing: Electro Polished
- Features:

- .Corrosion-resistant, hardened & tempered blade
- .High leverage design to save strength
- .Sharp curved blades with special serrated edge design ensures non-slip, smooth cutting
- .Multi-function shears for kitchen and camping

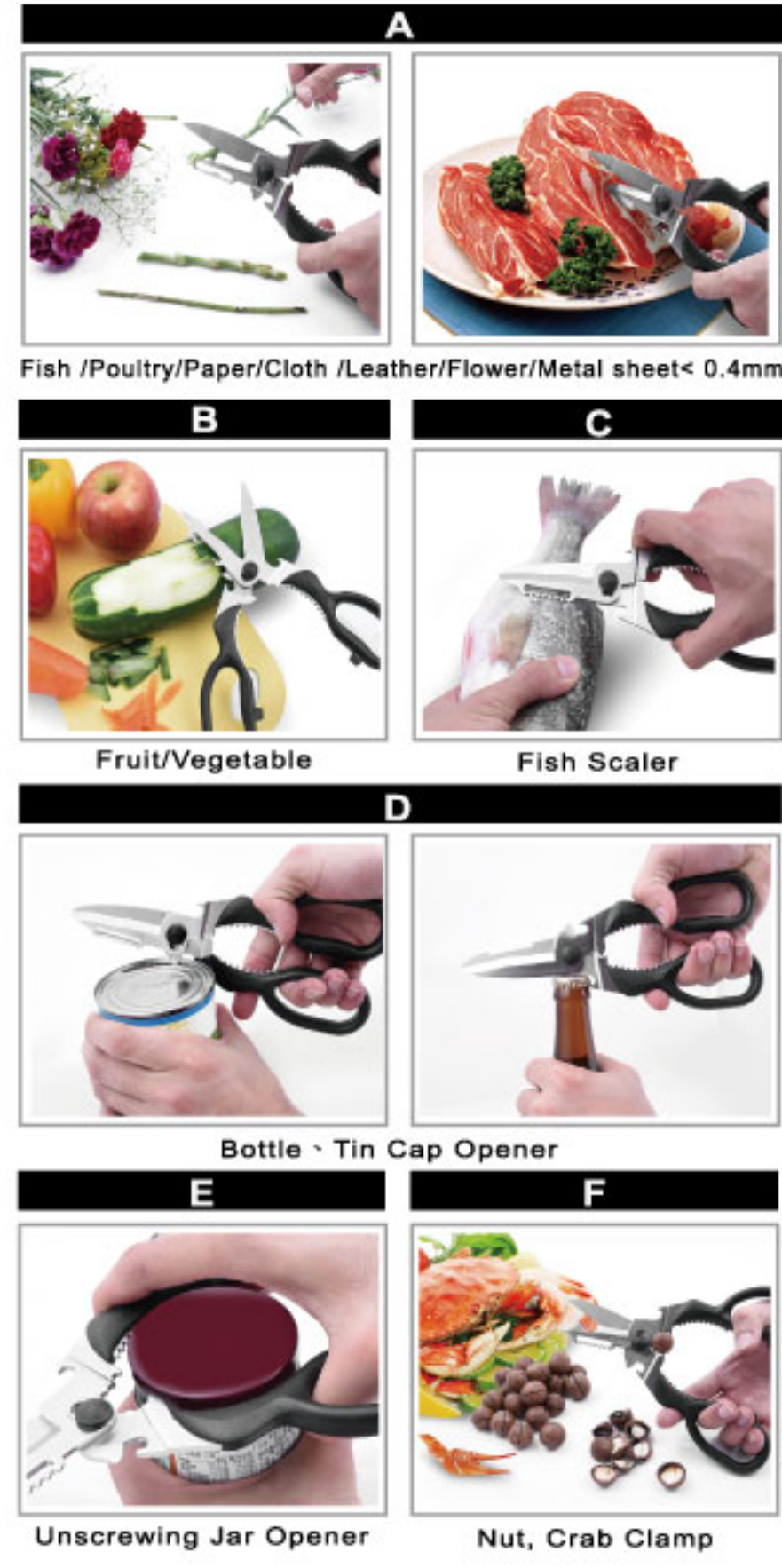

CHILI	T (mm)	ℓ (mm)	L (mm)	Weight	Box
C22130V	3.0	65	223	194	12/72

Packing way : sliding card

WORN-RIVAL HEX WRENCH

- Raw material: S2
- Finishing: Blue Satin
- Features:

- .Tip specialized patent design ensure be quick and efficient in loosening worn out hex bolt
- .Convex edge of tip is good working on severely hex bolt when pushing down and turning to force hex key
- .Reusable storage holder for easy tools retrieval

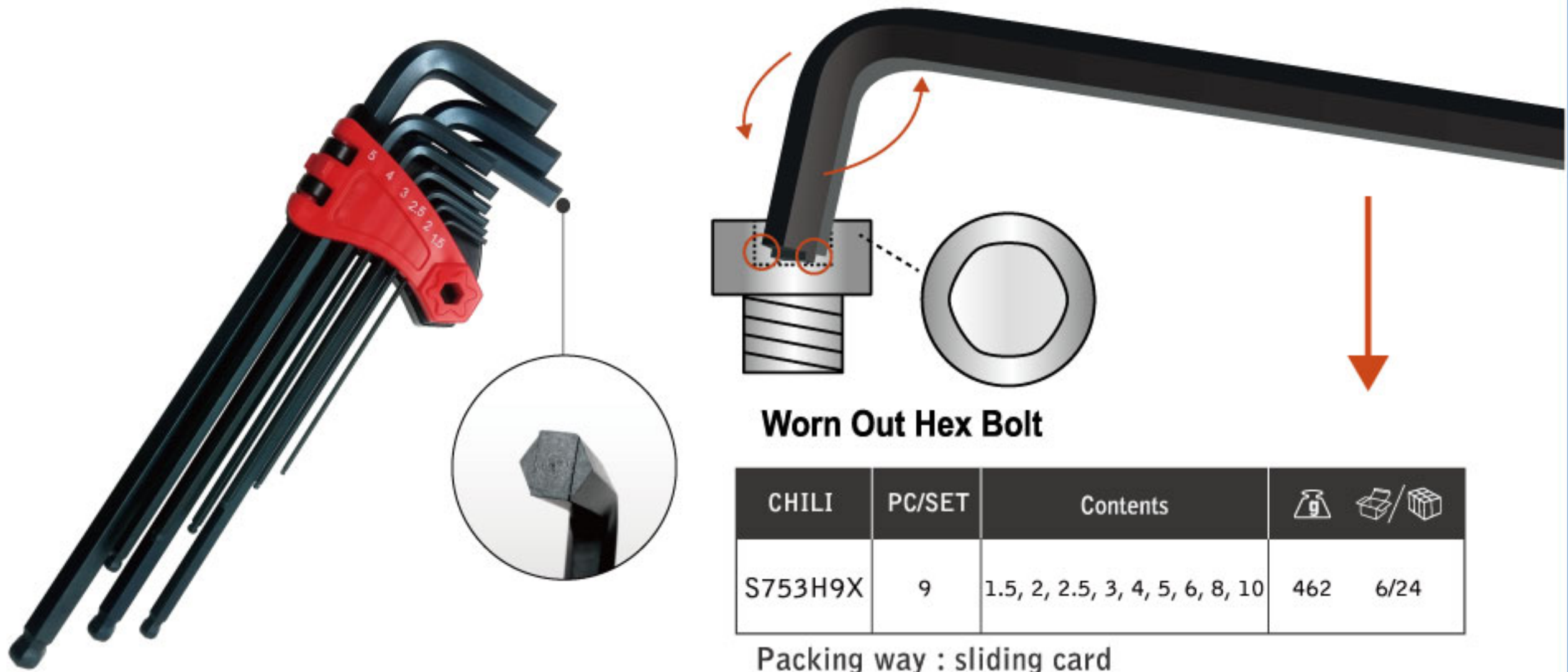

CHILI	PC/SET	Contents	Weight	Box
S753H9X	9	1.5, 2, 2.5, 3, 4, 5, 6, 8, 10	462	6/24

Packing way : sliding card