

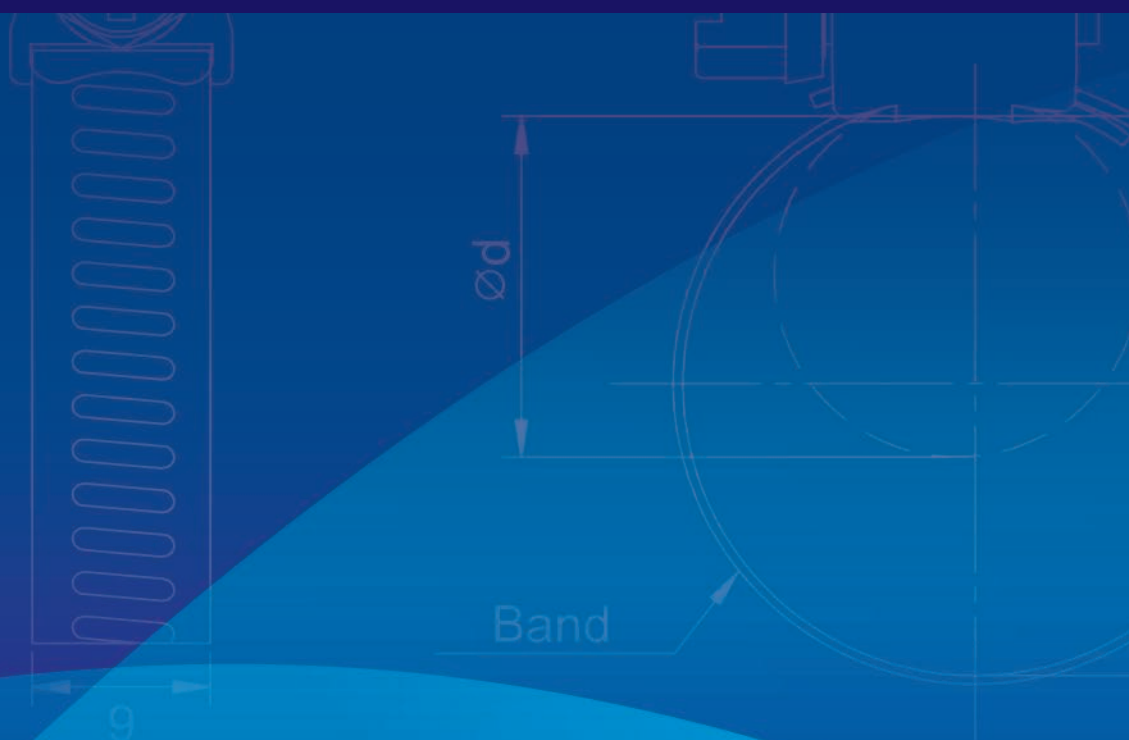

CATALOGUE  
**EVEREON**

THE EXPERT IN SUPPLYING HOSE CLAMPS





# EVEREON HOSE CLAMPS

Since 1993, EVEREON INDUSTRIES, INC. (YDS Hose Clamp) was founded; we have devoted ourselves to provide various hose clamps with easy, durable and safe connection for our customers to add value in their business relationship by creating more revenue and cost savings.

For over 20 years of experience and effort in this field, EVEREON's achievement has earned us respect and good reputation from customers. We will continue to develop quality products and service to satisfy our valued customers.

Welcome you to partner with us to create win-win situation.

## *Responsibility of YDS*

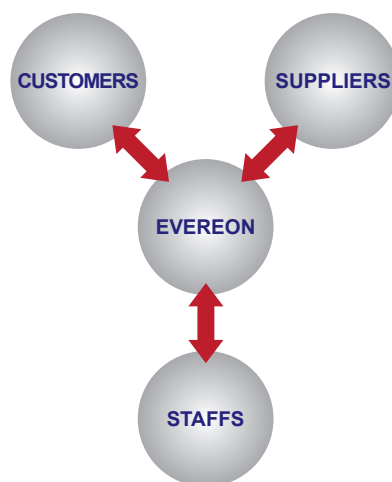

### *Development*

To continue developing in technics to satisfy customers.

### *Safety*

Safe and quality hose clamp bring you the better life.

Above symbol of working closely with **CUSTOMERS, SUPPLIERS, STAFFS and EVEREON.**



## 2014 >

Installing Barcode system in production process.

## 2013 >

Relocating our new factory for expanding overseas business.

## 2012 >

Setting more than 10 new production lines and improving the mechanical efficiency through automation.

## 2009 >

Opening a Branch in Shanghai, China.

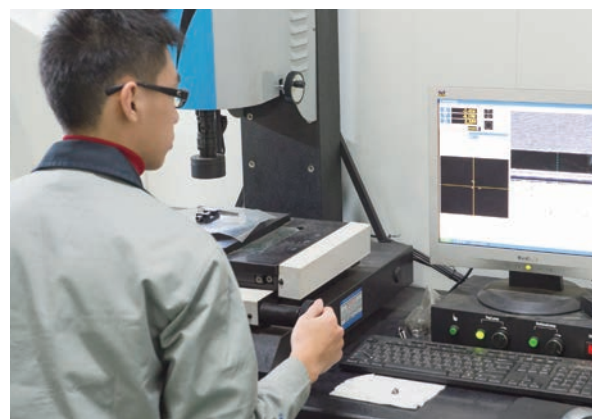

Innovation, Quality, Satisfaction.

## 2008 >

All products are produced under RoHS and REACH standard inspected by SGS.

## 2007 >

Implementing ERP (Enterprise Resource Planning) system.

## 2004 >

Gaining ISO 9001 certification by AFAQ.

## 1999 >

Logo  has been registered.

## 1995 >

Accomplishing the production lines of Embossed Worm Gear Hose Clamps.

## 1993 >

EVEREON INDUSTRIES, INC. was established.

With the aim of guaranteeing our customers to have the high quality hose clamps, we have ISO 9001 certification, and our integral teams of R&D, engineering, production and QC departments to test and certify our clamp performance to strengthen industrial standards.







W4



W2



W5



## Embossed Worm Gear Hose Clamps - 9 mm

- In accordance with DIN 3017 standard
- Under RoHS & REACH standard
- The smooth concave-convex stamped band and flared edge prevent hoses from damaging and extruding during installation
- Material and clamping range are stamped on band
- Multi-range hose clamps
- Larger diameters are available on request
- Various packaging are available on request

# Embossed Worm Gear Hose Clamps

- 9 mm Band Width



Embossed Worm Gear Hose Clamps with 9 mm band width are our general hose clamps, these are suitable for various common applications.

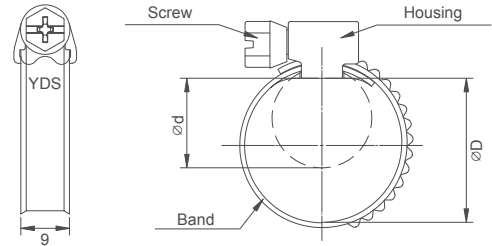

|           |                |          |                     |
|-----------|----------------|----------|---------------------|
| <b>W2</b> | 0.6t x 9w Band | Housing  | 7 mm Hex Head Screw |
|           | 430 S.S.       | 430 S.S. | Plated Carbon Steel |

|           |                |          |                     |
|-----------|----------------|----------|---------------------|
| <b>W4</b> | 0.6t x 9w Band | Housing  | 7 mm Hex Head Screw |
|           | 304 S.S.       | 304 S.S. | 304 S.S.            |

|           |                |          |                     |
|-----------|----------------|----------|---------------------|
| <b>W5</b> | 0.6t x 9w Band | Housing  | 7 mm Hex Head Screw |
|           | 316 S.S.       | 316 S.S. | 316 S.S.            |

| Band Width | Clamping Range |      |        |        | Part Number   |               |               |
|------------|----------------|------|--------|--------|---------------|---------------|---------------|
|            | mm             |      | inch   |        | W2 (430 S.S.) | W4 (304 S.S.) | W5 (316 S.S.) |
|            | Min.           | Max. | Min.   | Max.   | 3.0-4.0 Nm    | 4.0-5.0 Nm    | 5.0-6.0 Nm    |
| 9 mm       | 8              | 12   | 5/16   | 1/2    | Y121-09W012   | Y141-09W012   | Y152-09W012   |
|            | 10             | 16   | 3/8    | 5/8    | Y121-09W016   | Y141-09W016   | Y152-09W016   |
|            | 12             | 20   | 1/2    | 3/4    | Y121-09W020   | Y141-09W020   | Y152-09W020   |
|            | 12             | 22   | 1/2    | 7/8    | Y121-09W022   | Y141-09W022   | Y152-09W022   |
|            | 16             | 25   | 5/8    | 1      | Y121-09W025   | Y141-09W025   | Y152-09W025   |
|            | 16             | 27   | 5/8    | 1-1/16 | Y121-09W027   | Y141-09W027   | Y152-09W027   |
|            | 20             | 32   | 3/4    | 1-1/4  | Y121-09W032   | Y141-09W032   | Y152-09W032   |
|            | 25             | 40   | 1      | 1-5/8  | Y121-09W040   | Y141-09W040   | Y152-09W040   |
|            | 30             | 45   | 1-3/16 | 1-3/4  | Y121-09W045   | Y141-09W045   | Y152-09W045   |
|            | 32             | 50   | 1-1/4  | 2      | Y121-09W050   | Y141-09W050   | Y152-09W050   |
|            | 40             | 60   | 1-5/8  | 2-3/8  | Y121-09W060   | Y141-09W060   | Y152-09W060   |
|            | 50             | 70   | 2      | 2-3/4  | Y122-09W070   | Y142-09W070   | Y152-09W070   |
|            | 60             | 80   | 2-3/8  | 3-1/8  | Y122-09W080   | Y142-09W080   | Y152-09W080   |
|            | 70             | 90   | 2-3/4  | 3-1/2  | Y122-09W090   | Y142-09W090   | Y152-09W090   |
|            | 80             | 100  | 3-1/8  | 4      | Y122-09W100   | Y142-09W100   | Y152-09W100   |
|            | 90             | 110  | 3-1/2  | 4-3/8  | Y122-09W110   | Y142-09W110   | Y152-09W110   |
|            | 100            | 120  | 4      | 4-3/4  | Y122-09W120   | Y142-09W120   | Y152-09W120   |



W4



W2



W5



## Embossed Worm Gear Hose Clamps - 12 mm

- In accordance with DIN 3017 standard
- Under RoHS & REACH standard
- The smooth concave-convex stamped band and flared edge prevent hoses from damaging and extruding during installation
- Material and clamping range are stamped on band
- Multi-range hose clamps
- Larger diameters are available on request
- Various packaging are available on request

# Embossed Worm Gear Hose Clamps

-12 mm Band Width



Embossed Worm Gear Hose Clamps with 12 mm band width are suitable for various industrial applications of high torque or high pressure.

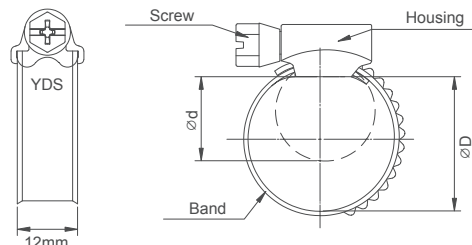

|           |                 |          |                     |
|-----------|-----------------|----------|---------------------|
| <b>W2</b> | 0.7t x 12w Band | Housing  | 7 mm Hex Head Screw |
|           | 430 S.S.        | 430 S.S. | Plated Carbon Steel |

|           |                 |          |                     |
|-----------|-----------------|----------|---------------------|
| <b>W4</b> | 0.7t x 12w Band | Housing  | 7 mm Hex Head Screw |
|           | 304 S.S.        | 304 S.S. | 304 S.S.            |

|           |                 |          |                     |
|-----------|-----------------|----------|---------------------|
| <b>W5</b> | 0.7t x 12w Band | Housing  | 7 mm Hex Head Screw |
|           | 316 S.S.        | 316 S.S. | 316 S.S.            |

| Band Width | Clamping Range |      |        |        | Part Number   |               |               |
|------------|----------------|------|--------|--------|---------------|---------------|---------------|
|            | mm             |      | inch   |        | W2 (430 S.S.) | W4 (304 S.S.) | W5 (316 S.S.) |
|            | Min.           | Max. | Min.   | Max.   | 3.5-4.5 Nm    | 4.5-5.5 Nm    | 5.5-6.5 Nm    |
| 12 mm      | 16             | 25   | 5/8    | 1      | Y121-12W025   | Y141-12W025   | Y152-12W025   |
|            | 16             | 27   | 5/8    | 1-1/16 | Y121-12W027   | Y141-12W027   | Y152-12W027   |
|            | 20             | 32   | 3/4    | 1-1/4  | Y121-12W032   | Y141-12W032   | Y152-12W032   |
|            | 25             | 40   | 1      | 1-5/8  | Y121-12W040   | Y141-12W040   | Y152-12W040   |
|            | 30             | 45   | 1-3/16 | 1-3/4  | Y121-12W045   | Y141-12W045   | Y152-12W045   |
|            | 32             | 50   | 1-1/4  | 2      | Y121-12W050   | Y141-12W050   | Y152-12W050   |
|            | 40             | 60   | 1-5/8  | 2-3/8  | Y121-12W060   | Y141-12W060   | Y152-12W060   |
|            | 50             | 70   | 2      | 2-3/4  | Y121-12W070   | Y141-12W070   | Y152-12W070   |
|            | 60             | 80   | 2-3/8  | 3-1/8  | Y121-12W080   | Y141-12W080   | Y152-12W080   |
|            | 70             | 90   | 2-3/4  | 3-1/2  | Y121-12W090   | Y141-12W090   | Y152-12W090   |
|            | 80             | 100  | 3-1/8  | 4      | Y121-12W100   | Y141-12W100   | Y152-12W100   |
|            | 90             | 110  | 3-1/2  | 4-3/8  | Y121-12W110   | Y141-12W110   | Y152-12W110   |
|            | 100            | 120  | 4      | 4-3/4  | Y121-12W120   | Y141-12W120   | Y152-12W120   |
|            | 110            | 130  | 4-3/8  | 5-1/8  | Y121-12W130   | Y141-12W130   | Y152-12W130   |
|            | 120            | 140  | 4-3/4  | 5-1/2  | Y121-12W140   | Y141-12W140   | Y152-12W140   |
|            | 130            | 150  | 5-1/8  | 5-7/8  | Y121-12W150   | Y141-12W150   | Y152-12W150   |
|            | 140            | 160  | 5-1/2  | 6-1/4  | Y121-12W160   | Y141-12W160   | Y152-12W160   |



## Micro Hose Clamps

- Under RoHS & REACH standard
- The smooth concave-convex stamped band and flared edge prevent hoses from damaging and extruding during installation



## Butterfly Hose Clamps

- In accordance with DIN 3017 standard
- Under RoHS & REACH standard
- The smooth concave-convex stamped band and flared edge prevent hoses from damaging and extruding during installation
- The handle is designed to resist aging and fatiguing under outdoor
- The hose clamps are reusable
- Multi-range hose clamps
- Various packaging are available on request



# Micro Hose Clamps



Micro Hose Clamps are designed for specific applications which are limited in narrow spaces or low pressure.

|           |                  |          |                     |
|-----------|------------------|----------|---------------------|
| <b>W2</b> | 0.5t x 6.5w Band | Housing  | 5 mm Hex Head Screw |
|           | 430 S.S.         | 430 S.S. | Plated Carbon Steel |

| Band Width | Clamping Range |      |       |      | Part Number   |
|------------|----------------|------|-------|------|---------------|
|            | mm             |      | inch  |      | W2 (430 S.S.) |
|            | Min.           | Max. | Min.  | Max. | 1.0 Nm        |
| 6.5 mm     | 7              | 11   | 9/32  | 7/16 | Y521A-0711    |
|            | 9              | 14   | 11/32 | 9/16 | Y521A-0714    |
|            | 10             | 19   | 3/8   | 3/4  | Y521A-0719    |

# Butterfly Hose Clamps



Butterfly Hose Clamps are designed for DIY and garden use without any tools.

|           |                |          |                     |             |
|-----------|----------------|----------|---------------------|-------------|
| <b>W2</b> | 0.6t x 9w Band | Housing  | Screw               | Grip Handle |
|           | 430 S.S.       | 430 S.S. | Plated Carbon Steel | POM         |

| Band Width | Clamping Range |      |        |        | Part Number   | Handle Color |
|------------|----------------|------|--------|--------|---------------|--------------|
|            | mm             |      | inch   |        | W2 (430 S.S.) |              |
|            | Min.           | Max. | Min.   | Max.   | 1.5-2.5 Nm    |              |
| 9 mm       | 8              | 12   | 5/16   | 1/2    | Y123-09W012   | BLUE         |
|            | 10             | 16   | 3/8    | 5/8    | Y123-09W016   | ORANGE       |
|            | 12             | 20   | 1/2    | 3/4    | Y123-09W020   | GREEN        |
|            | 12             | 22   | 1/2    | 7/8    | Y123-09W022   | YELLOW       |
|            | 16             | 25   | 5/8    | 1      | Y123-09W025   | BLUE         |
|            | 16             | 27   | 5/8    | 1-1/16 | Y123-09W027   | ORANGE       |
|            | 20             | 32   | 3/4    | 1-1/4  | Y123-09W032   | BLUE         |
|            | 25             | 40   | 1      | 1-5/8  | Y123-09W040   | BLUE         |
|            | 30             | 45   | 1-3/16 | 1-3/4  | Y123-09W045   | BLUE         |
|            | 32             | 50   | 1-1/4  | 2      | Y123-09W050   | BLUE         |
|            | 40             | 60   | 1-5/8  | 2-3/8  | Y123-09W060   | BLUE         |



400 SS



300 SS



316 SS

## Mini Hose Clamps

- Under RoHS & REACH Standard
- 3.0 Nm tightening torque is higher than common 8mm band width hose clamps
- The punched perforated band enables clamps to install easily and hold strong, and it is flexible for various conditions
- Multi-range hose clamps
- Material and clamping range are stamped on clamps
- Various packaging are available on request

# Mini Hose Clamps

- 3/8" (9 mm) Band Width



Mini Hose Clamps are innovated design with 9 mm band width, the tightening torque is 3.0 Nm.

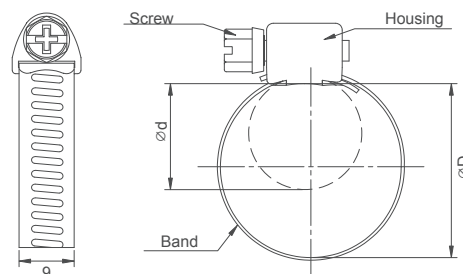

**400 SS**

|                |          |                            |
|----------------|----------|----------------------------|
| 0.6t x 9w Band | Housing  | 1/4"(6.4mm) Hex Head Screw |
| 430 S.S.       | 430 S.S. | Plated Carbon Steel        |

**300 SS**

|                |          |                            |
|----------------|----------|----------------------------|
| 0.6t x 9w Band | Housing  | 1/4"(6.4mm) Hex Head Screw |
| 304 S.S.       | 304 S.S. | 304 S.S.                   |

**316 SS**

|                |          |                            |
|----------------|----------|----------------------------|
| 0.6t x 9w Band | Housing  | 1/4"(6.4mm) Hex Head Screw |
| 316 S.S.       | 316 S.S. | 316 S.S.                   |

| SAE SIZE | Clamping Range |        |      |      | Part Number   |               |               |
|----------|----------------|--------|------|------|---------------|---------------|---------------|
|          | inch           |        | mm   |      | 400 S.S. (W2) | 300 S.S. (W4) | 316 S.S. (W5) |
|          | Min.           | Max.   | Min. | Max. | 3.0 Nm        | 3.5 Nm        | 3.5 Nm        |
| 2        | 1/4            | 1/2    | 6    | 13   | Y229-09W013   | Y249-09W013   | Y259-09W013   |
| 4        | 5/16           | 5/8    | 8    | 16   | Y229-09W016   | Y249-09W016   | Y259-09W016   |
| 5        | 7/16           | 3/4    | 11   | 20   | Y229-09W020   | Y249-09W020   | Y259-09W020   |
| 6        | 1/2            | 7/8    | 12   | 23   | Y229-09W023   | Y249-09W023   | Y259-09W023   |
| 8        | 1/2            | 1      | 13   | 25   | Y229-09W025   | Y249-09W025   | Y259-09W025   |
| 10       | 9/16           | 1-1/16 | 14   | 27   | Y229-09W027   | Y249-09W027   | Y259-09W027   |



400 SS



300 SS



316 SS

## Worm Drive Hose Clamps

- In accordance with SAE J1508 standard
- Under RoHS & REACH standard
- The punched perforated band enables clamps to install easily and hold strong, and it is flexible for various conditions
- Multi-range hose clamps
- Material and clamping range are stamped on clamps
- Larger diameters are available on request
- Various packaging are available on request



# Worm Drive Hose Clamps

-1/2" (12.7 mm) Band Width



1/2" (12.7 mm) band width Worm Drive Hose Clamps are our common type, which are suitable for various industrial applications.

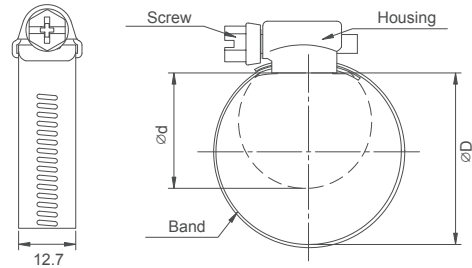

|               |                   |          |                              |
|---------------|-------------------|----------|------------------------------|
| <b>400 SS</b> | 0.6t x 12.7w Band | Housing  | 5/16" (7.9mm) Hex Head Screw |
|               | 430 S.S.          | 430 S.S. | Plated Carbon Steel          |

|               |                   |          |                              |
|---------------|-------------------|----------|------------------------------|
| <b>300 SS</b> | 0.6t x 12.7w Band | Housing  | 5/16" (7.9mm) Hex Head Screw |
|               | 304 S.S.          | 304 S.S. | 304 S.S.                     |

|               |                   |          |                              |
|---------------|-------------------|----------|------------------------------|
| <b>316 SS</b> | 0.6t x 12.7w Band | Housing  | 5/16" (7.9mm) Hex Head Screw |
|               | 316 S.S.          | 316 S.S. | 316 S.S.                     |

| SAE SIZE | Clamping Range |        |      |      | Part Number   |               |               |
|----------|----------------|--------|------|------|---------------|---------------|---------------|
|          | inch           |        | mm   |      | 400 S.S. (W2) | 300 S.S. (W4) | 316 S.S. (W5) |
|          | Min.           | Max.   | Min. | Max. | 4.0 Nm        | 4.5 Nm        | 4.5 Nm        |
| 6        | 1/2            | 7/8    | 12   | 23   | Y221-12.7W023 | Y241-12.7W023 | Y251-12.7W023 |
| 8        | 1/2            | 1      | 13   | 25   | Y221-12.7W025 | Y241-12.7W025 | Y251-12.7W025 |
| 10       | 9/16           | 1-1/16 | 14   | 27   | Y221-12.7W027 | Y241-12.7W027 | Y251-12.7W027 |
| 12       | 11/16          | 1-1/4  | 17   | 32   | Y221-12.7W032 | Y241-12.7W032 | Y251-12.7W032 |
| 16       | 11/16          | 1-1/2  | 17   | 38   | Y221-12.7W038 | Y241-12.7W038 | Y251-12.7W038 |
| 20       | 13/16          | 1-3/4  | 21   | 44   | Y221-12.7W044 | Y241-12.7W044 | Y251-12.7W044 |
| 24       | 1              | 2      | 25   | 51   | Y221-12.7W051 | Y241-12.7W051 | Y251-12.7W051 |
| 28       | 1-1/4          | 2-1/4  | 32   | 57   | Y221-12.7W057 | Y241-12.7W057 | Y251-12.7W057 |
| 32       | 1-1/2          | 2-1/2  | 38   | 63   | Y221-12.7W063 | Y241-12.7W063 | Y251-12.7W063 |
| 36       | 1-3/4          | 2-3/4  | 44   | 70   | Y221-12.7W070 | Y241-12.7W070 | Y251-12.7W070 |
| 40       | 2              | 3      | 51   | 76   | Y221-12.7W076 | Y241-12.7W076 | Y251-12.7W076 |
| 44       | 2-1/4          | 3-1/4  | 57   | 82   | Y221-12.7W082 | Y241-12.7W082 | Y251-12.7W082 |
| 48       | 2-1/2          | 3-1/2  | 64   | 89   | Y221-12.7W089 | Y241-12.7W089 | Y251-12.7W089 |
| 52       | 2-3/4          | 3-3/4  | 70   | 95   | Y221-12.7W095 | Y241-12.7W095 | Y251-12.7W095 |
| 56       | 3              | 4      | 76   | 102  | Y221-12.7W102 | Y241-12.7W102 | Y251-12.7W102 |
| 60       | 3-1/4          | 4-1/4  | 82   | 108  | Y221-12.7W108 | Y241-12.7W108 | Y251-12.7W108 |
| 64       | 3-1/2          | 4-1/2  | 89   | 114  | Y221-12.7W114 | Y241-12.7W114 | Y251-12.7W114 |
| 72       | 4              | 5      | 102  | 127  | Y221-12.7W127 | Y241-12.7W127 | Y251-12.7W127 |
| 80       | 4-1/2          | 5-1/2  | 114  | 140  | Y221-12.7W140 | Y241-12.7W140 | Y251-12.7W140 |
| 88       | 5              | 6      | 127  | 152  | Y221-12.7W152 | Y241-12.7W152 | Y251-12.7W152 |
| 96       | 5-1/2          | 6-1/2  | 140  | 165  | Y221-12.7W165 | Y241-12.7W165 | Y251-12.7W165 |
| 104      | 6              | 7      | 152  | 178  | Y221-12.7W178 | Y241-12.7W178 | Y251-12.7W178 |



Plated Head Screw



ALL 304SS



ALL 316SS

## High Torque Hose Clamps

- In accordance with SAE standard J1508 Type "F"
- Under RoHS & REACH Standard
- The housing structure is extremely stronger than others.
- The punched perforated band enables clamps to install easily and hold strongly, and it is flexible for various conditions
- Multi-range hose clamps
- Material and clamping range are stamped on clamps
- Larger diameters are available on request
- Various packaging are available on request

# High Torque Hose Clamps

- 1/2" (12.7 mm) Band Width



1/2" (12.7mm) band width High Torque Hose Clamps are designed for industrial applications of heavy-duty or high pressure. The tightening torque is over 10 Nm.

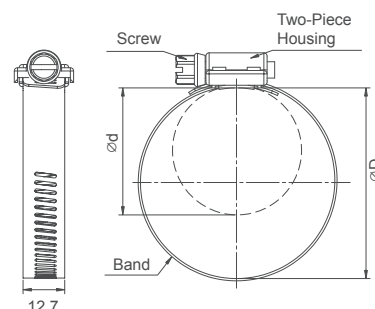

|                   |                   |          |                              |
|-------------------|-------------------|----------|------------------------------|
| Plated Head Screw | 0.6t x 12.7w Band | Housing  | 5/16" (7.9mm) Hex Head Screw |
|                   | 304 S.S.          | 304 S.S. | Plated Carbon Steel          |

|           |                   |          |                              |
|-----------|-------------------|----------|------------------------------|
| ALL 300SS | 0.6t x 12.7w Band | Housing  | 5/16" (7.9mm) Hex Head Screw |
|           | 304 S.S.          | 304 S.S. | 304 S.S.                     |

|           |                   |          |                              |
|-----------|-------------------|----------|------------------------------|
| ALL 316SS | 0.6t x 12.7w Band | Housing  | 5/16" (7.9mm) Hex Head Screw |
|           | 316 S.S.          | 316 S.S. | 316 S.S.                     |

| SAE SIZE | Clamping Range |        |      |      | Part Number       |               |               |
|----------|----------------|--------|------|------|-------------------|---------------|---------------|
|          | inch           |        | mm   |      | Plated Head Screw | ALL 300 S.S.  | ALL 316 S.S.  |
|          | Min.           | Max.   | Min. | Max. | 10.0 Nm           | 10.0 Nm       | 10.0 Nm       |
| 10       | 9/16           | 1-1/16 | 14   | 27   | Y238-12.7W027     | Y248-12.7W027 | Y258-12.7W027 |
| 12       | 11/16          | 1-1/4  | 17   | 32   | Y238-12.7W032     | Y248-12.7W032 | Y258-12.7W032 |
| 16       | 11/16          | 1-1/2  | 17   | 38   | Y238-12.7W038     | Y248-12.7W038 | Y258-12.7W038 |
| 20       | 13/16          | 1-3/4  | 21   | 44   | Y238-12.7W044     | Y248-12.7W044 | Y258-12.7W044 |
| 24       | 1              | 2      | 25   | 51   | Y238-12.7W051     | Y248-12.7W051 | Y258-12.7W051 |
| 28       | 1-1/4          | 2-1/4  | 32   | 57   | Y238-12.7W057     | Y248-12.7W057 | Y258-12.7W057 |
| 32       | 1-1/2          | 2-1/2  | 38   | 63   | Y238-12.7W063     | Y248-12.7W063 | Y258-12.7W063 |
| 36       | 1-3/4          | 2-3/4  | 44   | 70   | Y238-12.7W070     | Y248-12.7W070 | Y258-12.7W070 |
| 40       | 2              | 3      | 51   | 76   | Y238-12.7W076     | Y248-12.7W076 | Y258-12.7W076 |
| 44       | 2-1/4          | 3-1/4  | 57   | 82   | Y238-12.7W082     | Y248-12.7W082 | Y258-12.7W082 |
| 48       | 2-1/2          | 3-1/2  | 64   | 89   | Y238-12.7W089     | Y248-12.7W089 | Y258-12.7W089 |
| 52       | 2-3/4          | 3-3/4  | 70   | 95   | Y238-12.7W095     | Y248-12.7W095 | Y258-12.7W095 |
| 56       | 3              | 4      | 76   | 102  | Y238-12.7W102     | Y248-12.7W102 | Y258-12.7W102 |
| 60       | 3-1/4          | 4-1/4  | 82   | 108  | Y238-12.7W108     | Y248-12.7W108 | Y258-12.7W108 |
| 64       | 3-1/2          | 4-1/2  | 89   | 114  | Y238-12.7W114     | Y248-12.7W114 | Y258-12.7W114 |
| 72       | 4              | 5      | 102  | 127  | Y238-12.7W127     | Y248-12.7W127 | Y258-12.7W127 |
| 80       | 4-1/2          | 5-1/2  | 114  | 140  | Y238-12.7W140     | Y248-12.7W140 | Y258-12.7W140 |
| 88       | 5              | 6      | 127  | 152  | Y238-12.7W152     | Y248-12.7W152 | Y258-12.7W152 |
| 96       | 5-1/2          | 6-1/2  | 140  | 165  | Y238-12.7W165     | Y248-12.7W165 | Y258-12.7W165 |
| 104      | 6              | 7      | 152  | 178  | Y238-12.7W178     | Y248-12.7W178 | Y258-12.7W178 |



Y311



Y312



Y313

## Wire Hose Clamps



# Wire Hose Clamps



The wire hose clamps are only used in low pressure applications, all parts are plated with Cr3<sup>+</sup> Zinc coating under RoHS & REACH standard.

## Y311 - Wire Hose Clamps with Hex Head Screw

|                     |                     |                     |
|---------------------|---------------------|---------------------|
| Double Wires        | Hex Head Screw      | Bolt & Washer       |
| Plated Carbon Steel | Plated Carbon Steel | Plated Carbon Steel |

## Y312 - Wire Hose Clamps with Flat Head

|                     |                     |                     |
|---------------------|---------------------|---------------------|
| Double Wires        | Flat Head           | Bolt & Washer       |
| Plated Carbon Steel | Plated Carbon Steel | Plated Carbon Steel |

## Y313 - Wire Hose Clamps with Grip Handle

|                     |                     |                     |             |
|---------------------|---------------------|---------------------|-------------|
| Double Wires        | Screw               | Bolt & Washer       | Grip Handle |
| Plated Carbon Steel | Plated Carbon Steel | Plated Carbon Steel | POM         |

| Clamping Range |      |       |       | Part Number    |             |             |
|----------------|------|-------|-------|----------------|-------------|-------------|
| mm             |      | inch  |       | Hex Head Screw | Flat Head   | Grip Handle |
| Min.           | Max. | Min.  | Max.  |                |             |             |
| 7              | 10   | 1/4   | 3/8   | Y311-16D010    | Y312-16D010 | Y313-16D010 |
| 10             | 13   | 3/8   | 1/2   | Y311-16D013    | Y312-16D013 | Y313-16D013 |
| 13             | 16   | 1/2   | 5/8   | Y311-16D016    | Y312-16D016 | Y313-16D016 |
| 16             | 19   | 5/8   | 3/4   | Y311-16D019    | Y312-16D019 | Y313-16D019 |
| 18             | 23   | 3/4   | 7/8   | Y311-18D023    | Y312-18D023 | Y313-18D023 |
| 21             | 26   | 13/16 | 1     | Y311-18D026    | Y312-18D026 | Y313-18D026 |
| 26             | 32   | 1     | 1-1/4 | Y311-20D032    | Y312-20D032 | Y313-20D032 |
| 31             | 38   | 1-1/4 | 1-1/2 | Y311-20D038    | Y312-20D038 | Y313-20D038 |
| 38             | 45   | 1-1/2 | 1-3/4 | Y311-20D045    | Y312-20D045 | Y313-20D045 |
| 41             | 51   | 1-5/8 | 2     | Y311-23D051    | Y312-23D051 | Y313-23D051 |
| 47             | 57   | 1-7/8 | 2-1/4 | Y311-23D057    | Y312-23D057 | Y313-23D057 |
| 54             | 64   | 2-1/8 | 2-1/2 | Y311-23D064    | Y312-23D064 | Y313-23D064 |
| 60             | 70   | 2-3/8 | 2-3/4 | Y311-23D070    | Y312-23D070 | Y313-23D070 |
| 66             | 76   | 2-5/8 | 3     | Y311-23D076    | Y312-23D076 | Y313-23D076 |
| 79             | 89   | 3-1/8 | 3-1/2 | Y311-23D089    | Y312-23D089 | Y313-23D089 |
| 92             | 102  | 3-5/8 | 4     | Y311-23D102    | Y312-23D102 | Y313-23D102 |
| 104            | 114  | 4-1/8 | 4-1/2 | Y311-23D114    | Y312-23D114 | Y313-23D114 |
| 117            | 127  | 4-5/8 | 5     | Y311-23D127    | Y312-23D127 | Y313-23D127 |



## Single Ear Clamps

- Fast & easy connection
- Uniform compression



## Adjustable Ear Clamps

# Single Ear Clamps



Single Ear Clamps are suitable for fast and safe connection of pipes, and they make the pipes for uniform surface compression. The outside interlock, smooth band and burr-free edge prevent hoses from damaging during installation.



## Y449 - Single Ear Clamps

| Min. Dia (mm) | Max. Dia (mm) | Band Thickness (mm) | Band Width (mm) | Material | Part Number  |
|---------------|---------------|---------------------|-----------------|----------|--------------|
| 8.8           | 10.5          | 0.5                 | 5               | 304 S.S. | Y449-50W10.5 |
| 9.6           | 11.3          |                     |                 |          | Y449-50W11.3 |
| 10.8          | 13.3          | 0.6                 | 7               |          | Y449-70W13.3 |
| 12.8          | 15.3          |                     |                 |          | Y449-70W15.3 |
| 15.3          | 18.5          |                     |                 |          | Y449-70W18.5 |

# Adjustable Ear Clamps



The clamps can be adjusted by 5 positions for several range to fasten the hoses precisely.



## Y426 – Adjustable Ear Clamps-5 Adjustable Positions

| SIZE (mm) | Min. Dia (mm) | Max. Dia (mm) | Band Thickness (mm) | Band Width (mm) | Material             |
|-----------|---------------|---------------|---------------------|-----------------|----------------------|
| 30        | 22.0          | 30.0          | 0.5 or 0.6 mm       | 7 or 8 mm       | 430 S.S. or 304 S.S. |
| 32        | 24.0          | 32.0          |                     |                 |                      |
| 35        | 27.0          | 35.0          |                     |                 |                      |
| 40        | 32.0          | 40.0          |                     |                 |                      |
| 45        | 37.0          | 45.0          |                     |                 |                      |
| 50        | 42.0          | 50.0          |                     |                 |                      |



Y421



Y423



Y424

## CV Joint Boot Clamps



# CV Joint Boot Clamps



These clamps are specific used in CV (Constant-Velocity) Joint Boot of Auto.



## Y421 - Free End Clamps

| Part No.    | Thickness (mm) | Width (mm) | Length (mm) | Material |
|-------------|----------------|------------|-------------|----------|
| Y421-63W360 | 0.3            | 6.4        | 360         | 430 S.S. |
| Y421-63W740 | 0.3            | 6.4        | 740         |          |



## Y423 - Inside Interlock

| Part No.    | Thickness (mm) | Width (mm) | Length (mm) | Material | Clamping Range (mm) |      |
|-------------|----------------|------------|-------------|----------|---------------------|------|
|             |                |            |             |          | Min.                | Max. |
| Y423-64W160 | 0.5            | 6.4        | 160         | 430 S.S. | 27                  | 38   |
| Y423-80W425 | 0.6            | 8.0        | 425         |          | 45                  | 115  |

## Y424 - Outside Interlock

| Part No.    | Thickness (mm) | Width (mm) | Length (mm) | Material | Clamping Range (mm) |      |
|-------------|----------------|------------|-------------|----------|---------------------|------|
|             |                |            |             |          | Min.                | Max. |
| Y424-70W245 | 0.5            | 7.0        | 245         | 430 S.S. | 32                  | 58   |
| Y424-70W405 | 0.5            | 7.0        | 405         |          | 73                  | 108  |

# Accessories

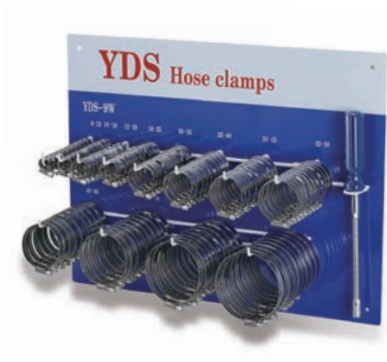

Y6101 Iron Plate:  
120 pcs clamps in 12 10-packs in  
sizes Ø12, Ø16, Ø20, Ø25, Ø32,  
Ø40, Ø45, Ø50, Ø60, Ø70, Ø80, Ø90



Y6103 Clamp Rack:  
110 pcs clamps in 11 10-packs in  
sizes Ø12, Ø16, Ø20, Ø25, Ø32,  
Ø40, Ø45, Ø50, Ø60, Ø70, Ø80



Y6005  
Tools for Free End Clamp



YF6303  
Pliers



Y6001  
Nut Drivers

# Packaging



Blister Cards Packaging  
4 / 2 pcs Blister Cards Packaging



Polybags Packaging  
2 pcs Polybags Packaging



Tag Packaging  
1 pcs Tag Packaging



Bulk Pack Boxes Blue  
100 / 50 pcs Bulk Pack



Bulk Pack Boxes Green  
100 / 50 pcs Bulk Pack



10-Packs Boxes  
10 pcs Sub Pack

# Customized Products



Y225 Corrugated Pipe Clamps



Lined Clamps



Y144F V Clamps



Y129 Bridge Hose Clamps



Gap, Hole Special Type



Cable Tie



Y224 Trapezoid Clamps



Y144 Straight Clamps



Y246 Band Clamps

EVEREON



QUALITY COMES FROM  
OUR ATTENTION TO ALL THE DETAILS



**EVEREON INDUSTRIES, INC.**

NO. 25, Ln. 215, Caohu Rd., Wufeng Dist.,  
Taichung City 413, Taiwan  
Tel: 886-4-2339 9907  
Fax: 886-4-2339 8677  
E-Mail: [info@evereon.com.tw](mailto:info@evereon.com.tw)  
Web: [www.evereon.com.tw](http://www.evereon.com.tw)



2019.1 EVEREON ALL RIGHTS RESERVED